

DETALLE CURVATURA ARCOS e:1/75

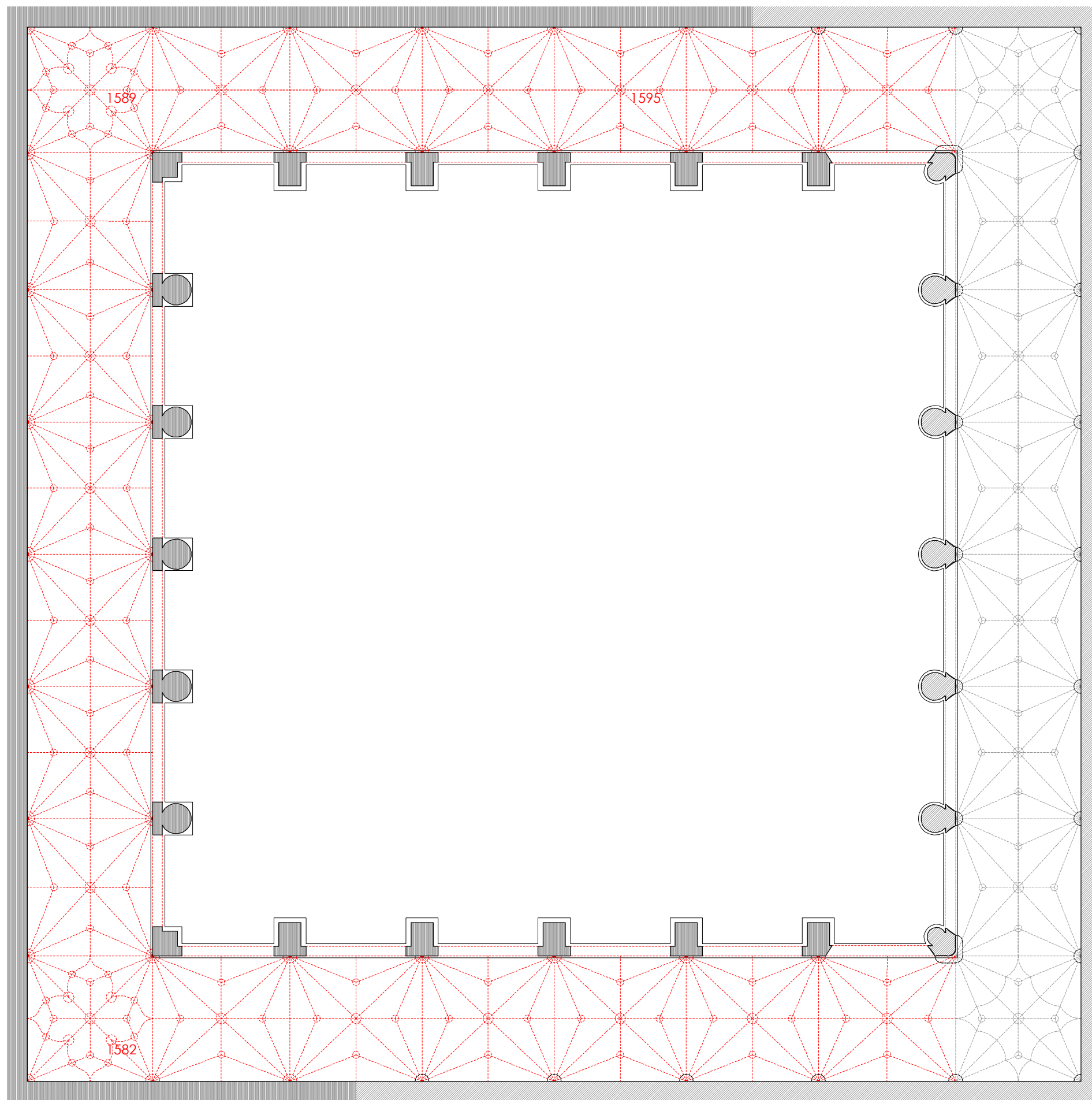

- INTERVENCIÓN BADAJOZ-PÁMANES-HERRERA
- INTERVENCIÓN MATEO LÓPEZ
- BÓVEDAS BADAJOZ-PÁMANES-HERRERA
- BÓVEDAS MATEO LÓPEZ
- MÉNSULAS BADAJOZ-PÁMANES-HERRERA
- MÉNSULAS MATEO LÓPEZ

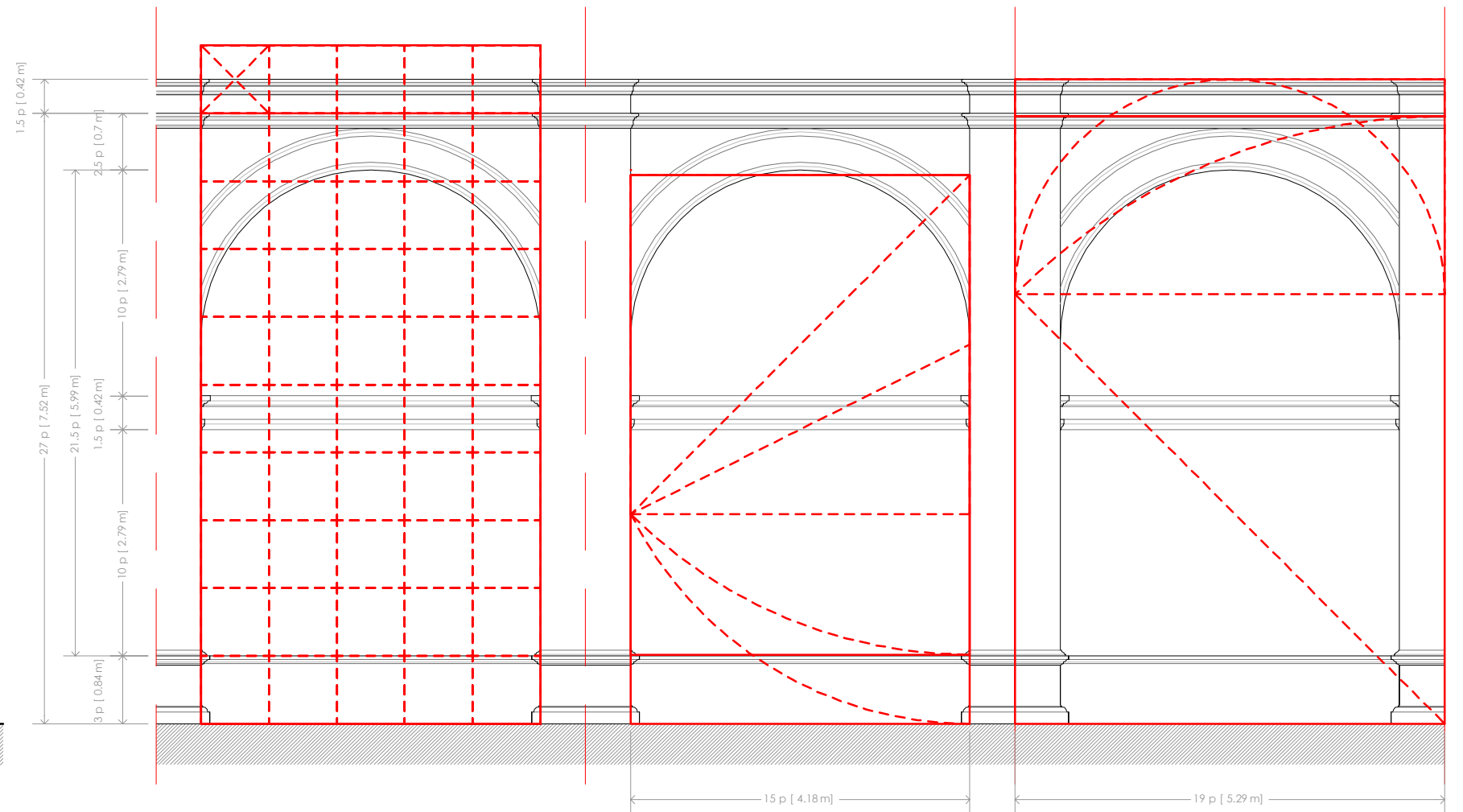

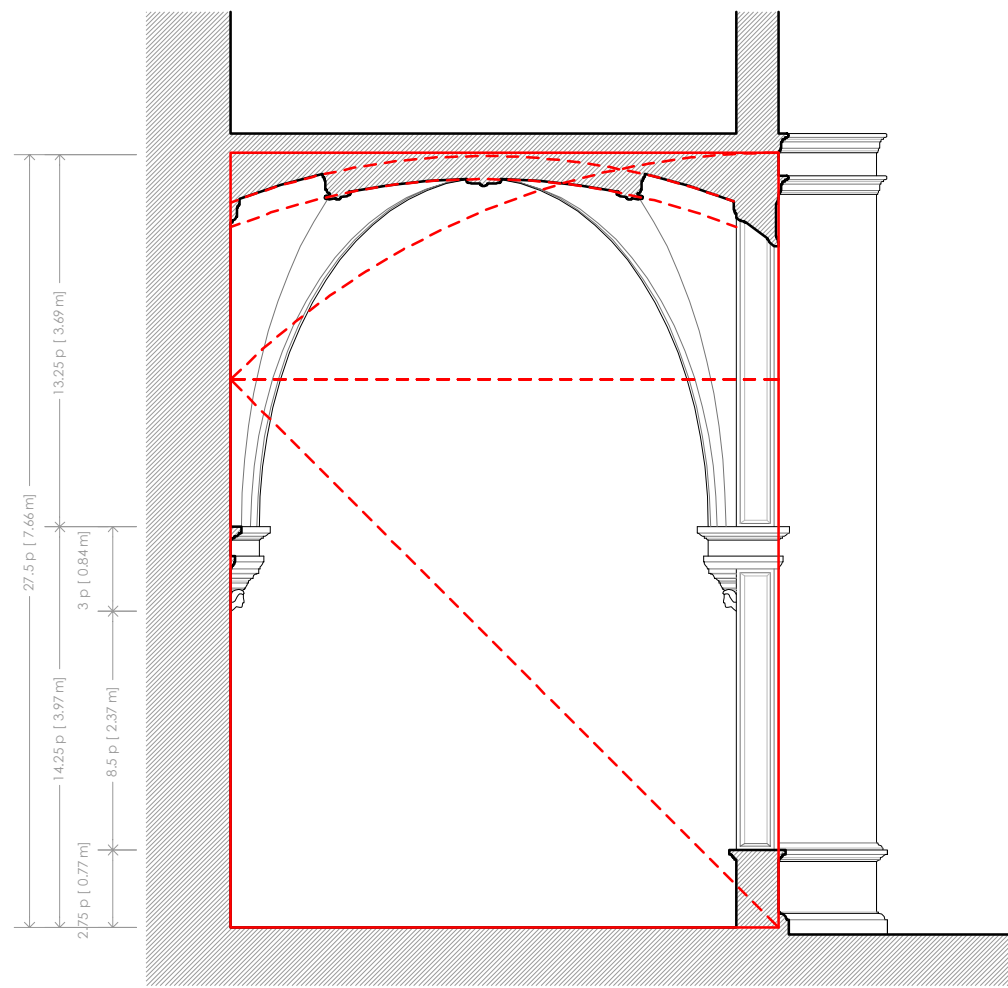

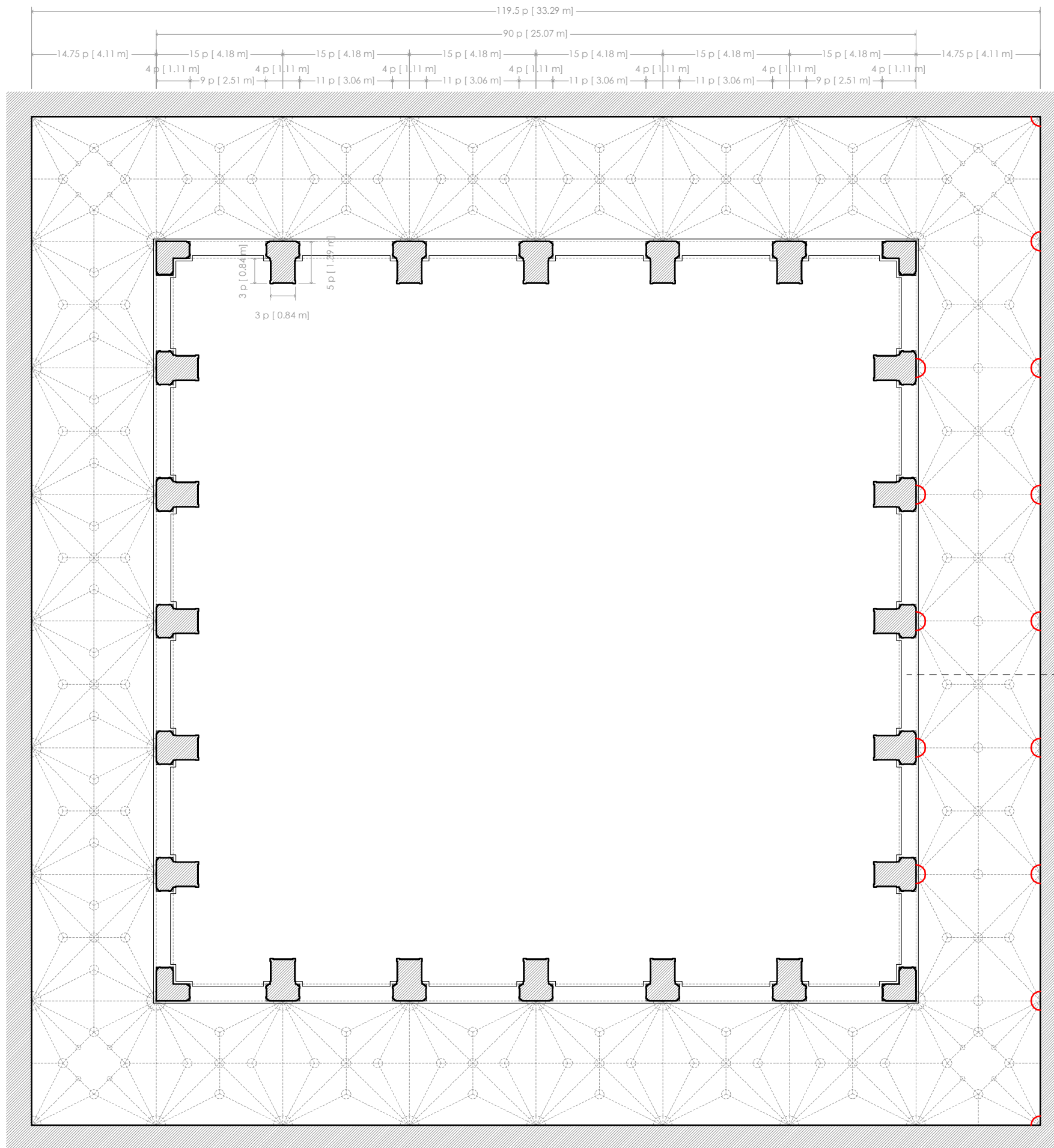

DETALLE CURVATURA ARCOS e:1/75 →

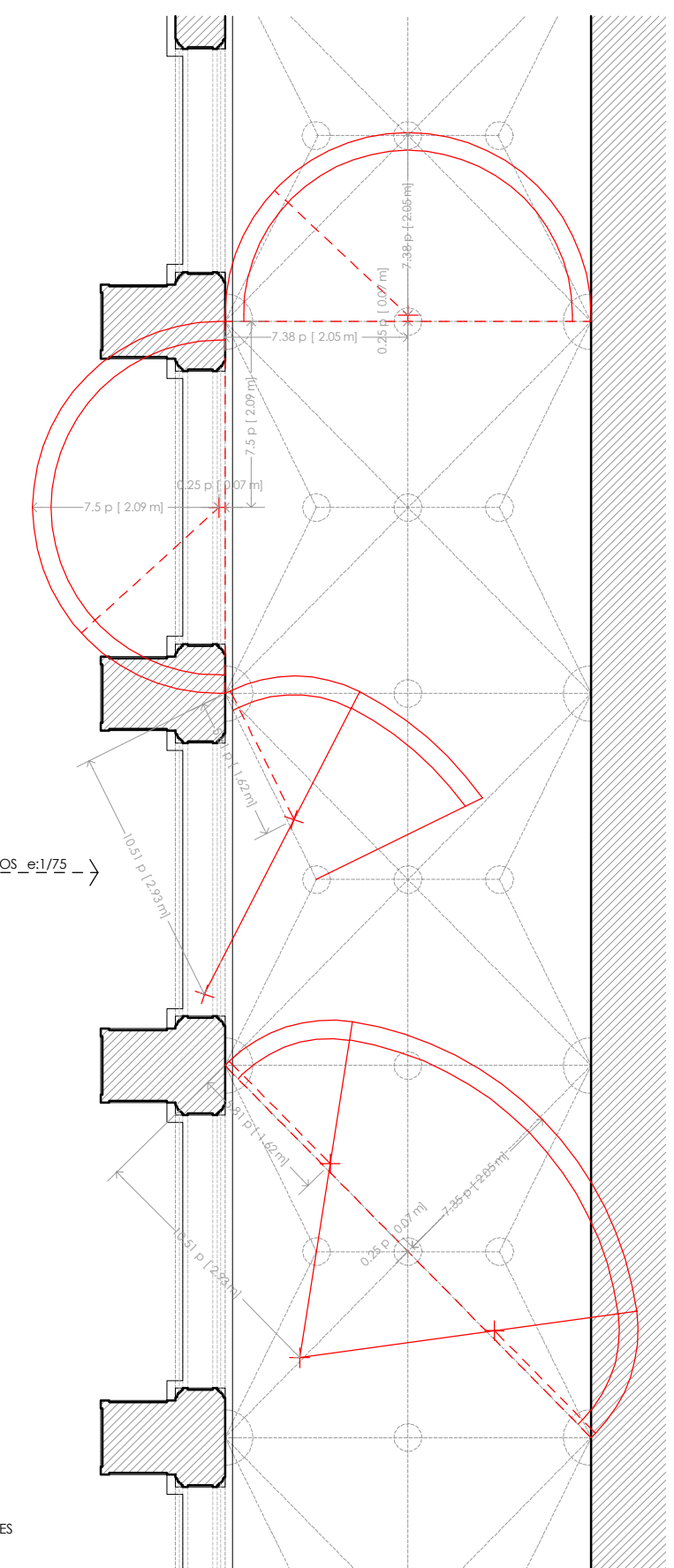

◡ MÉNSULAS PÁMANES

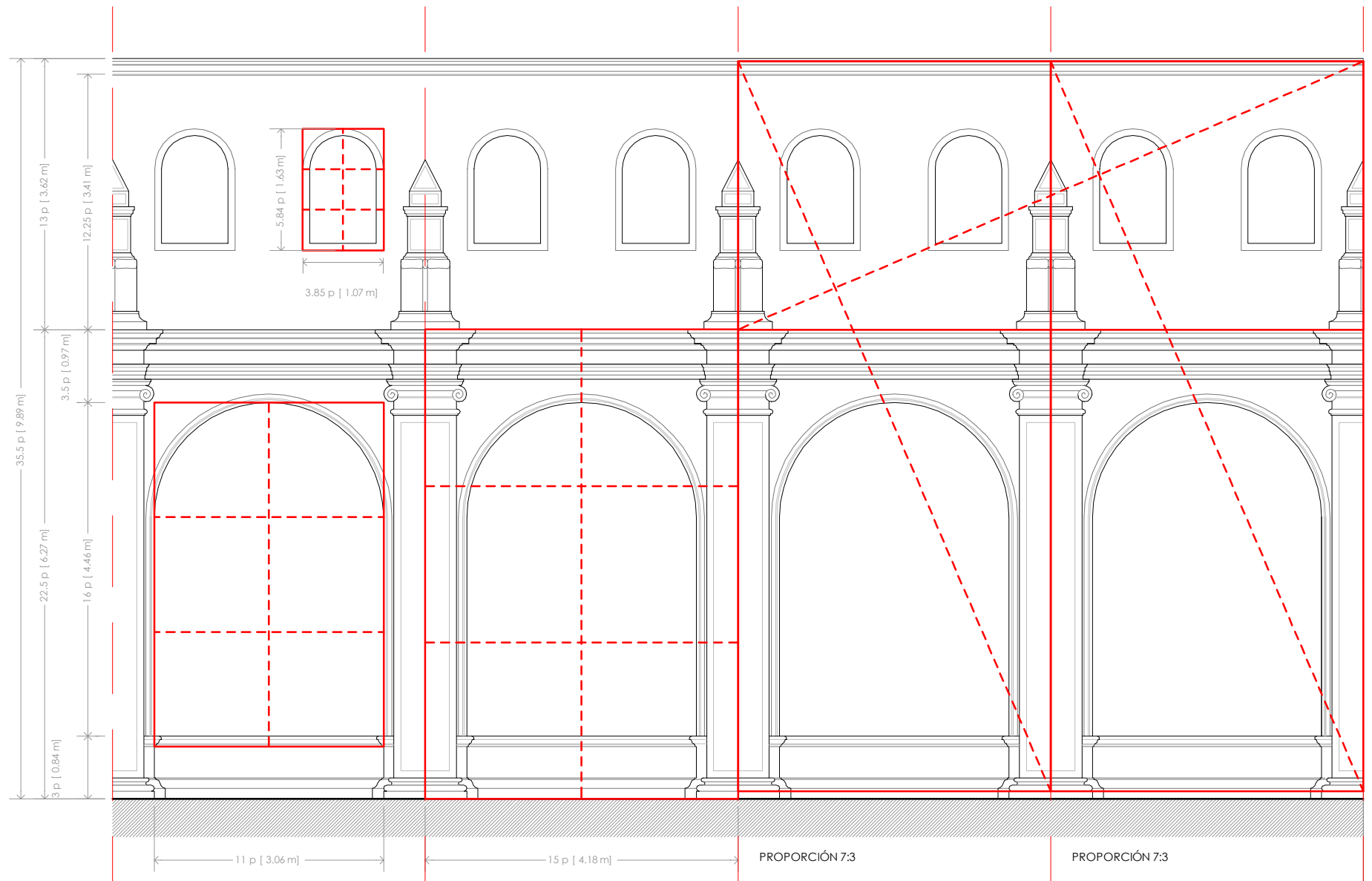
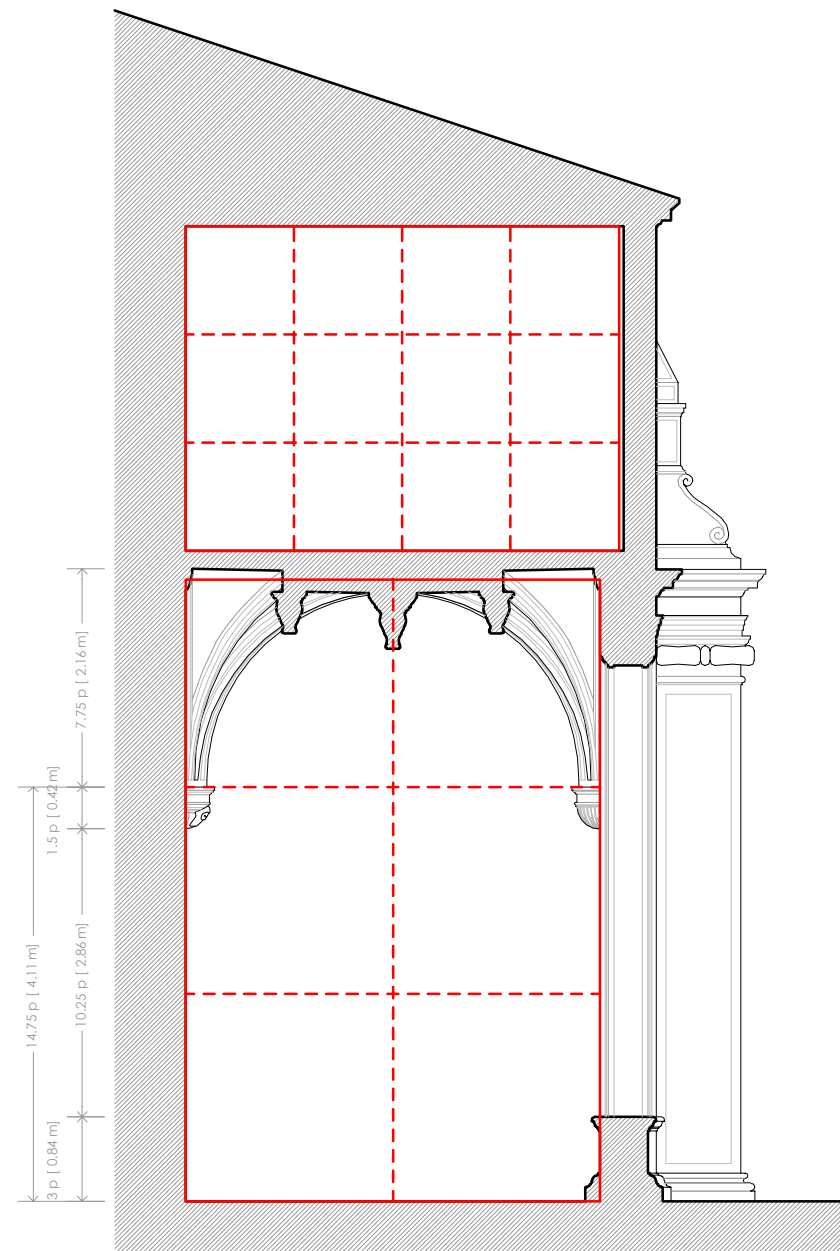

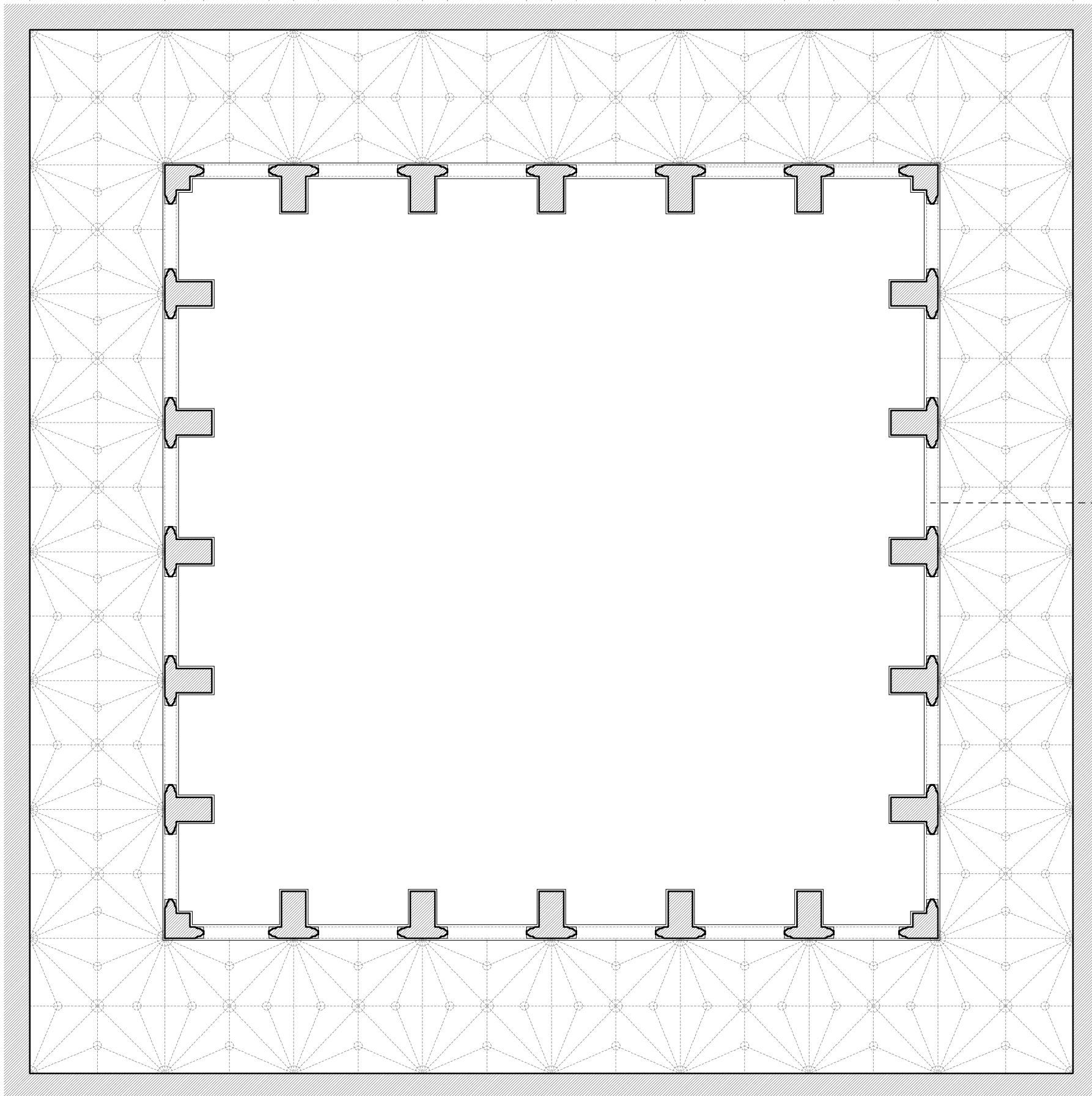
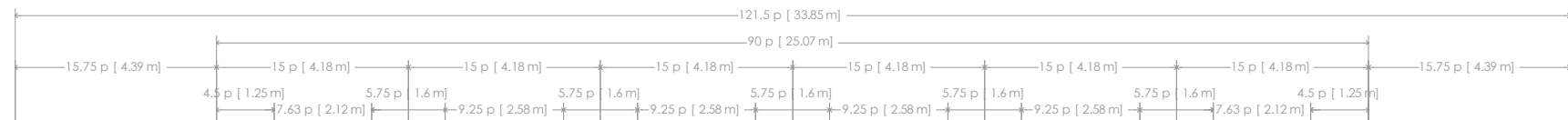

DETALLE CURVATURA ARCOS e:1/75

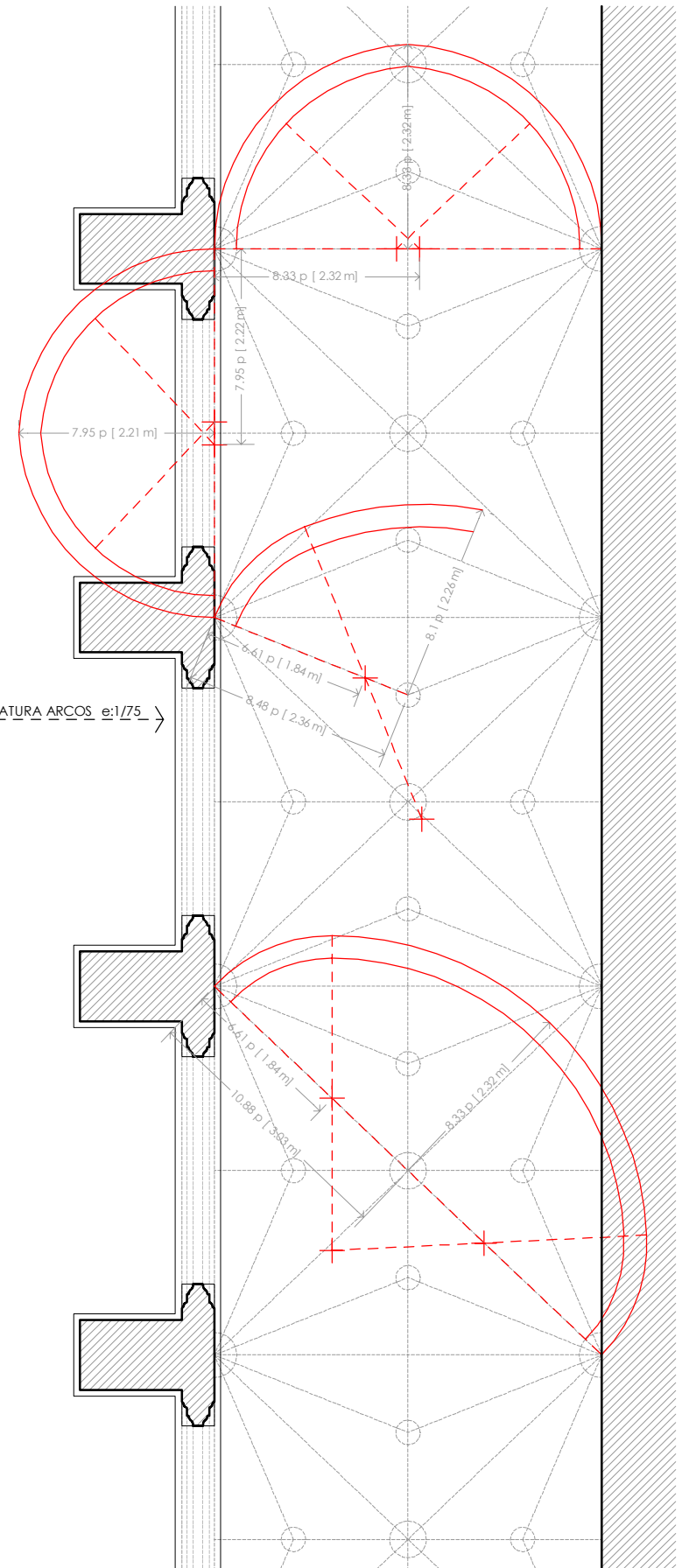

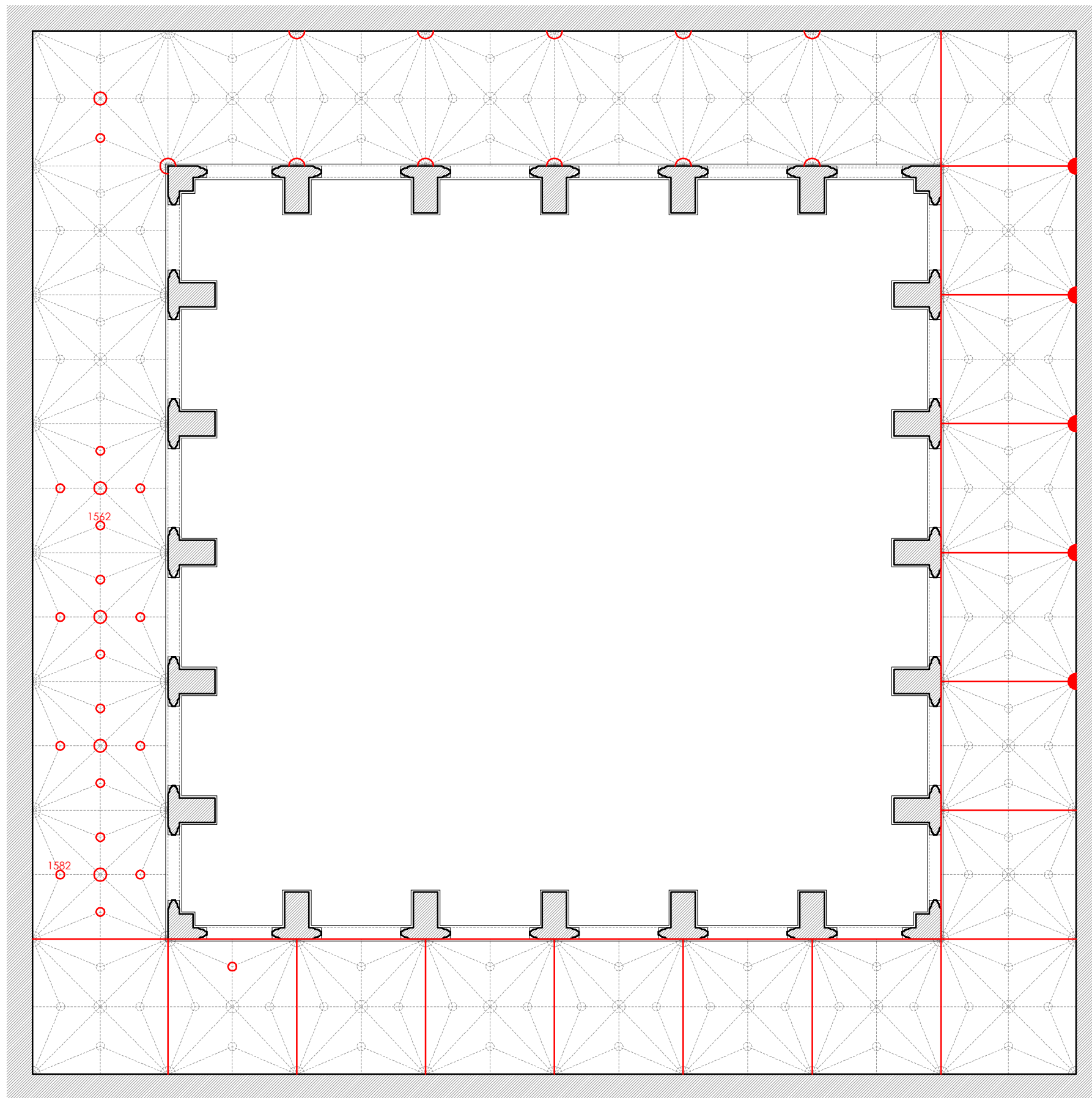

- ARCOS PERPIAÑOS Y FORMEROS APUNTADOS
- ARCOS PERPIAÑOS Y FORMEROS DE MEDIO PUNTO
- CLAVES CON FORMA DE MEDALLA, DECORADAS CON PERSONAJES, SÍMBOLOS O FECHAS.
- CLAVES CON FORMA DE MEDALLA, DECORADAS CON MOTIVOS VEGETALES O GEOMÉTRICOS
- ◐ MÉNSULAS PLATERESCAS
- ◑ MÉNSULAS DE ENTABLEMIENTO TRONCOCÓNICO CON CIERTA DECORACIÓN
- ◑ MÉNSULAS DE ENTABLEMIENTO TRONCOCÓNICO AUSTERAS

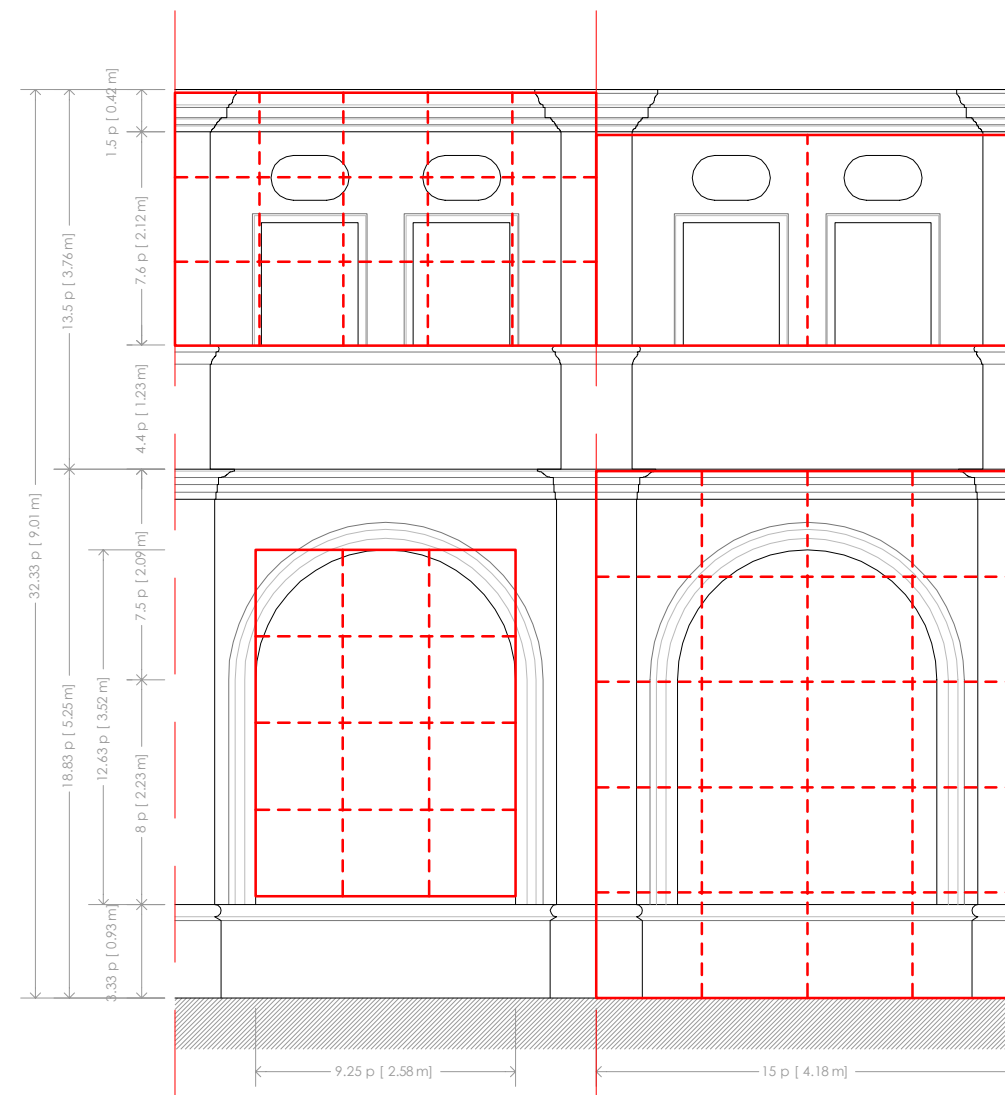
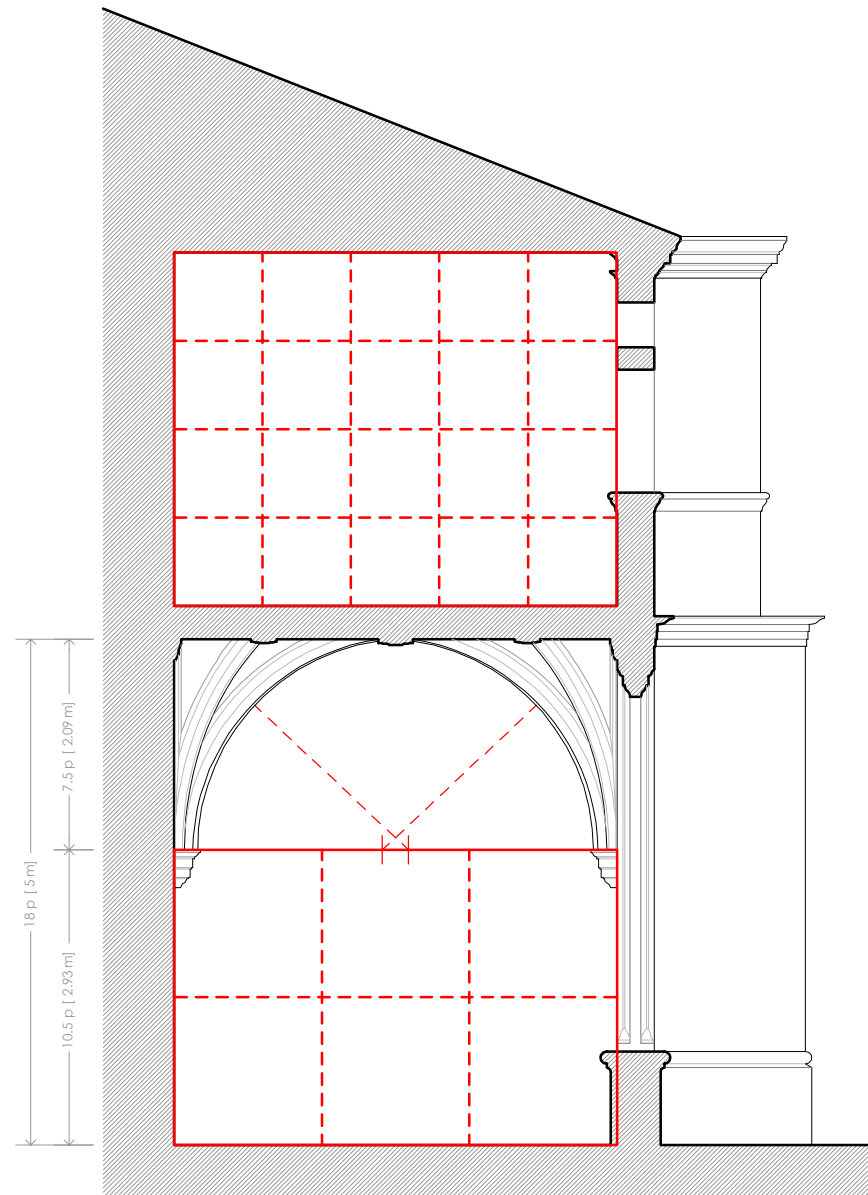



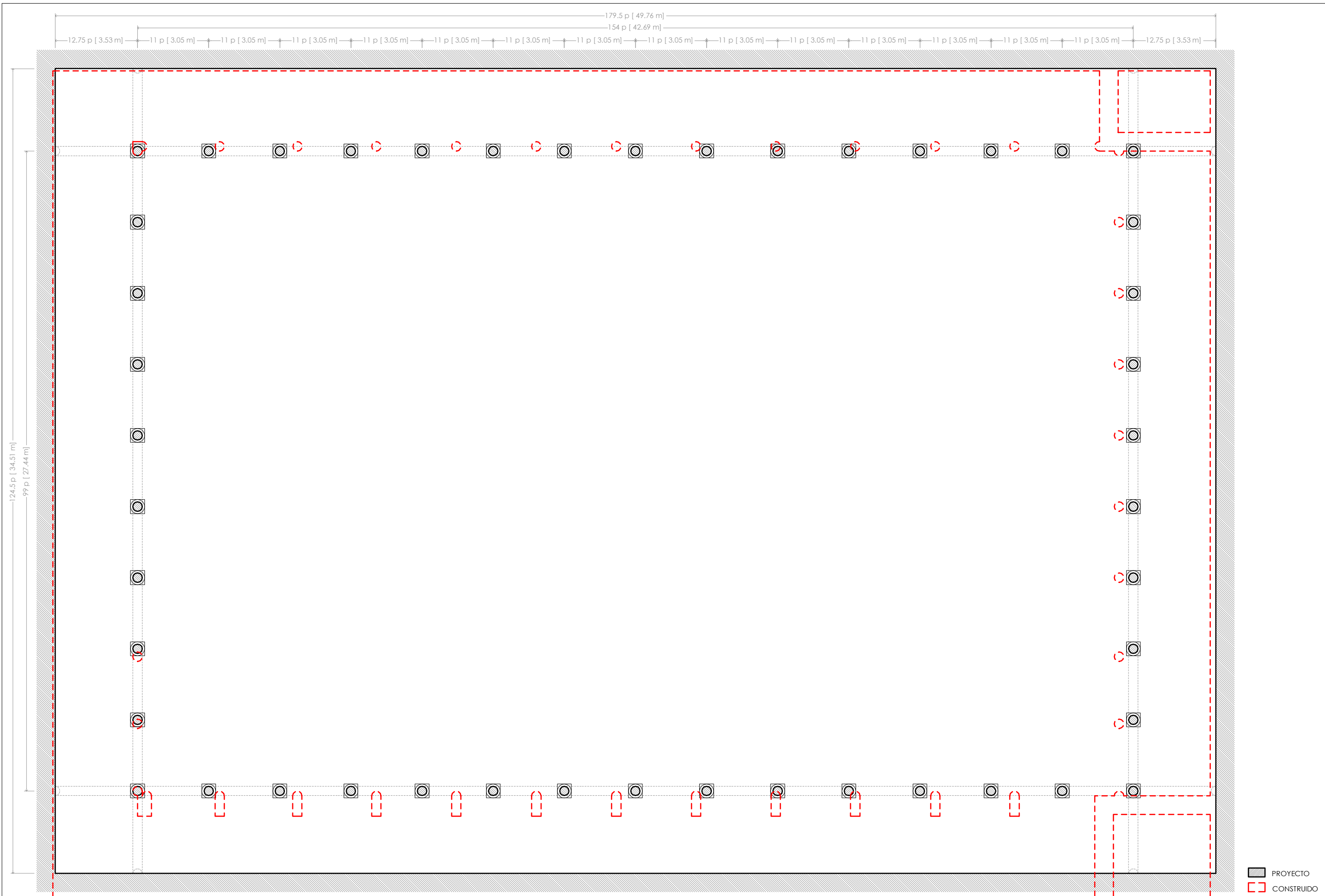

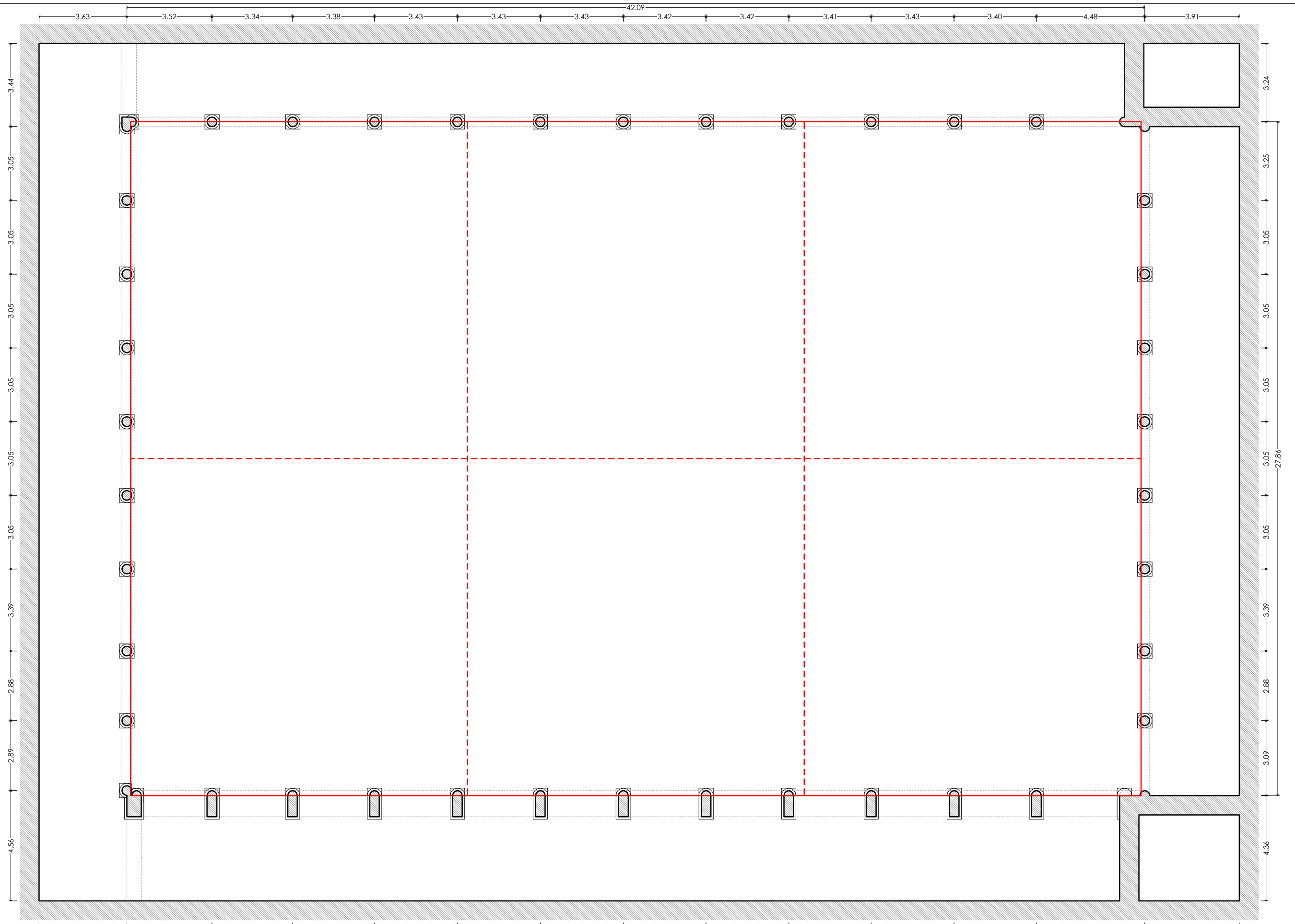

TERCER PISO: INTERVENCIÓN POSTERIOR →

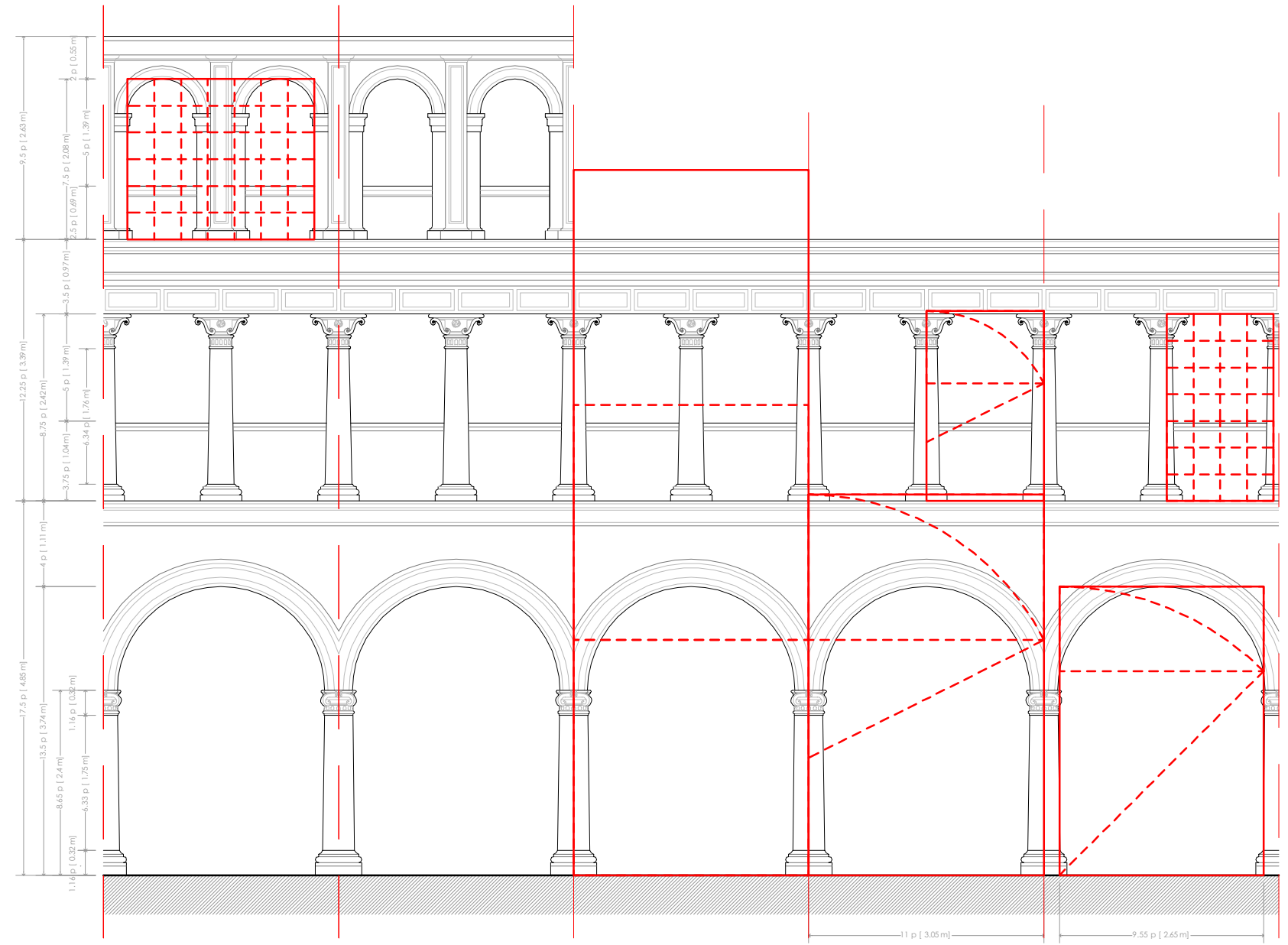

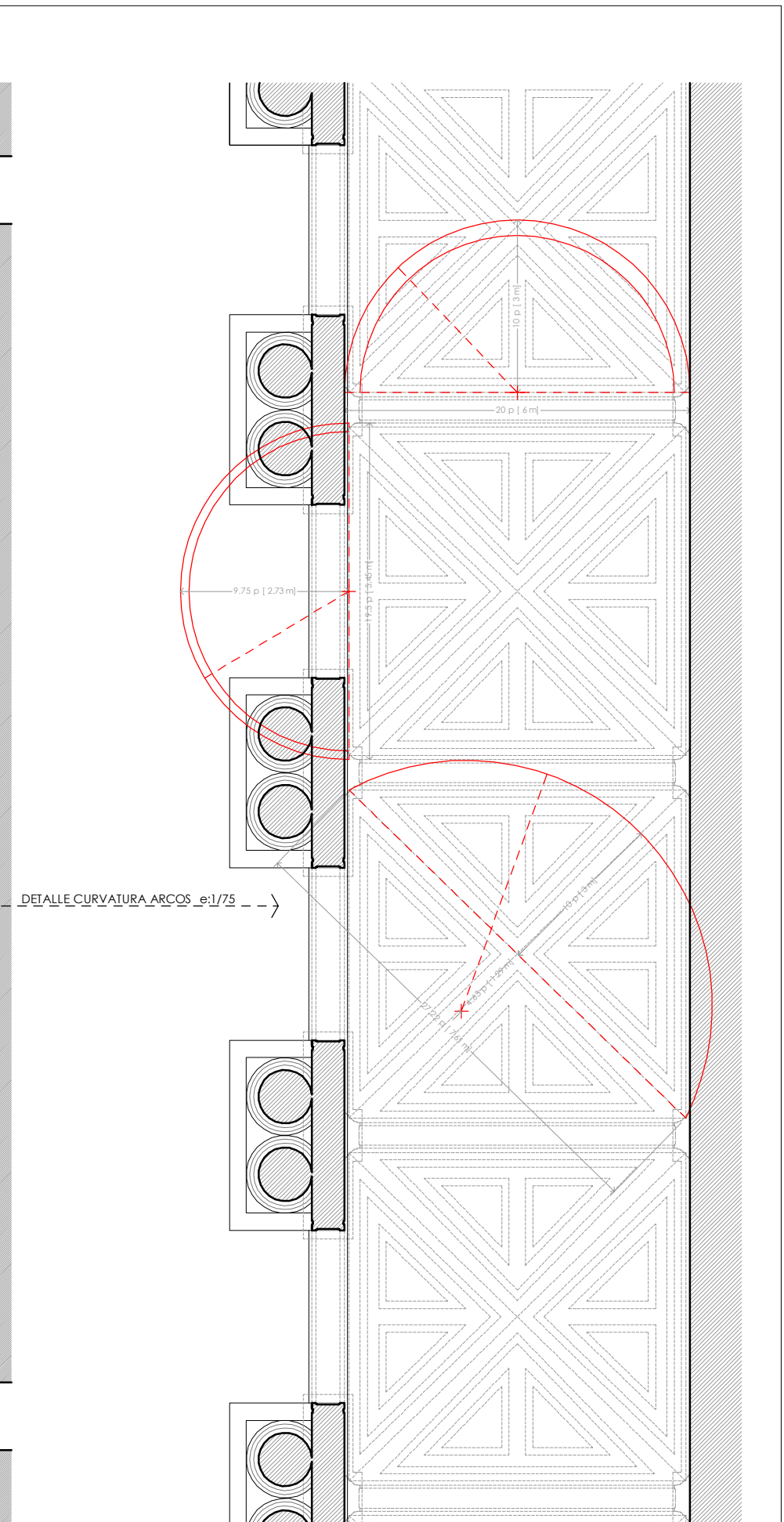
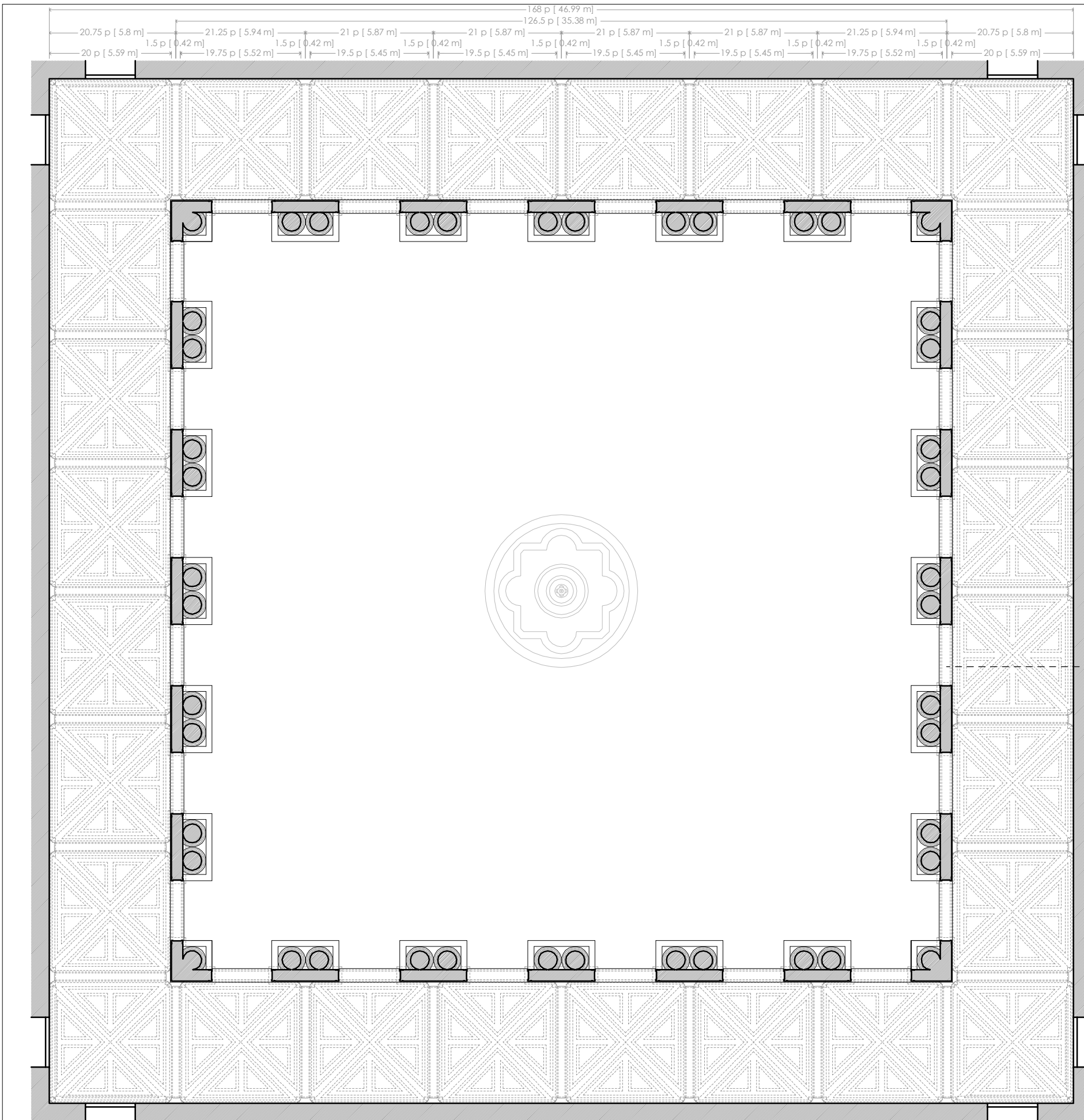



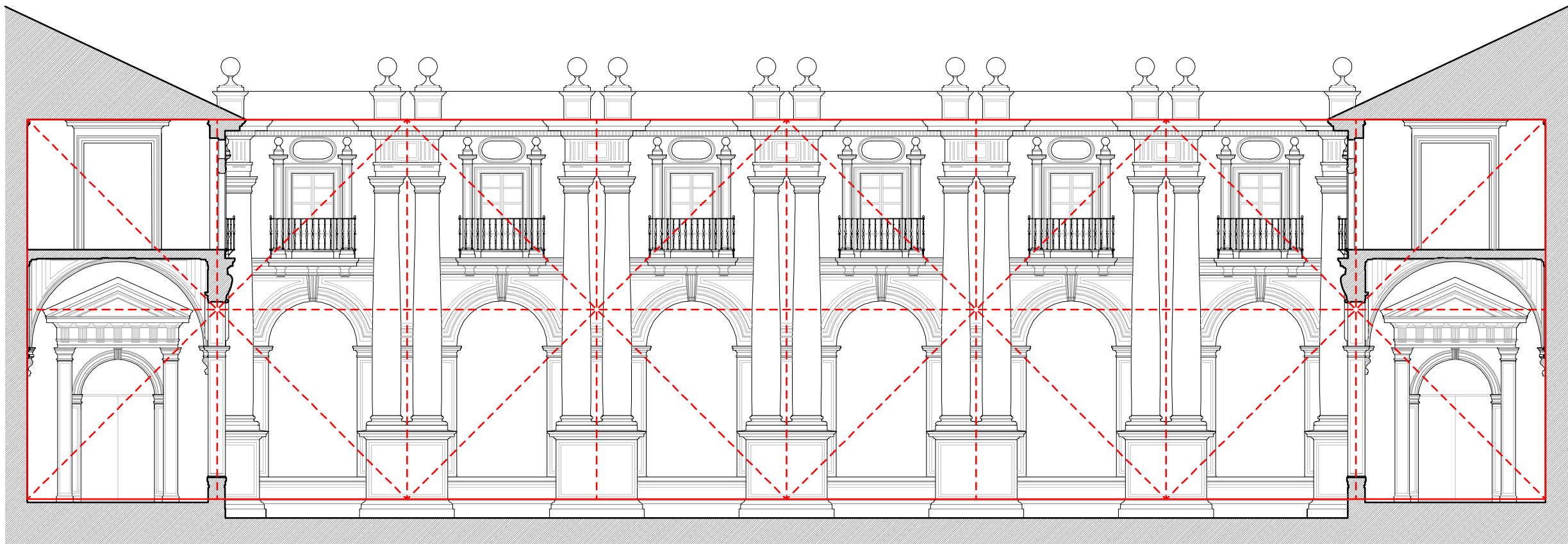
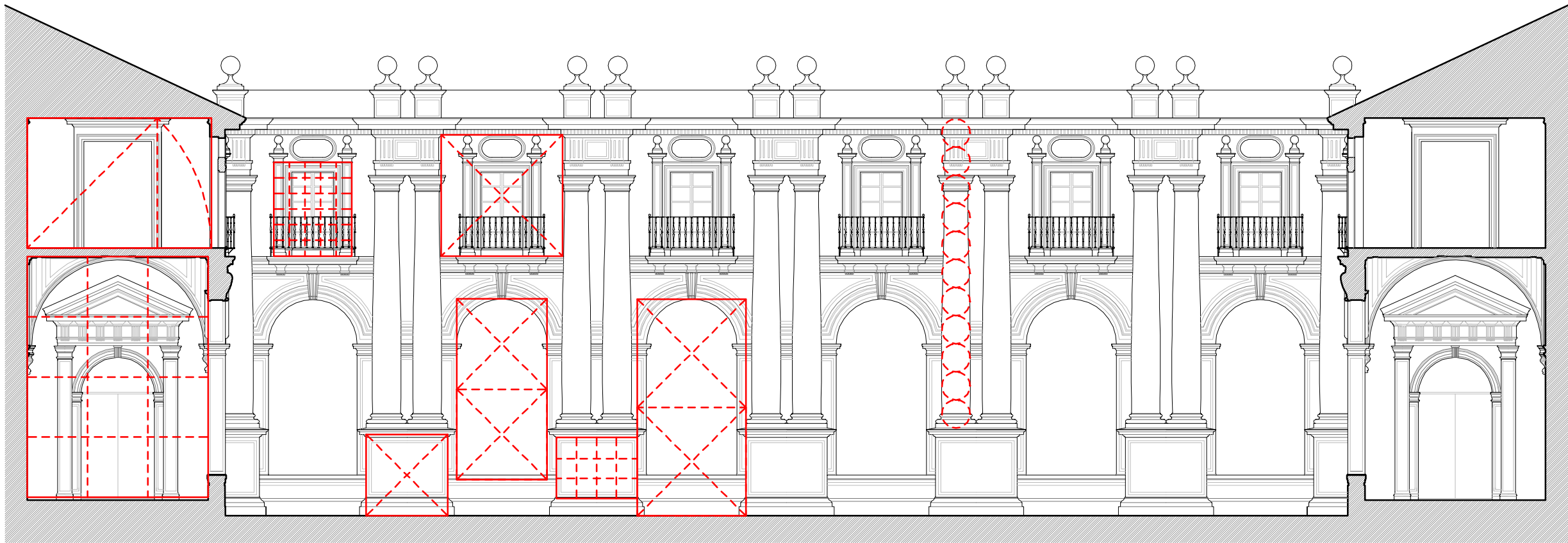

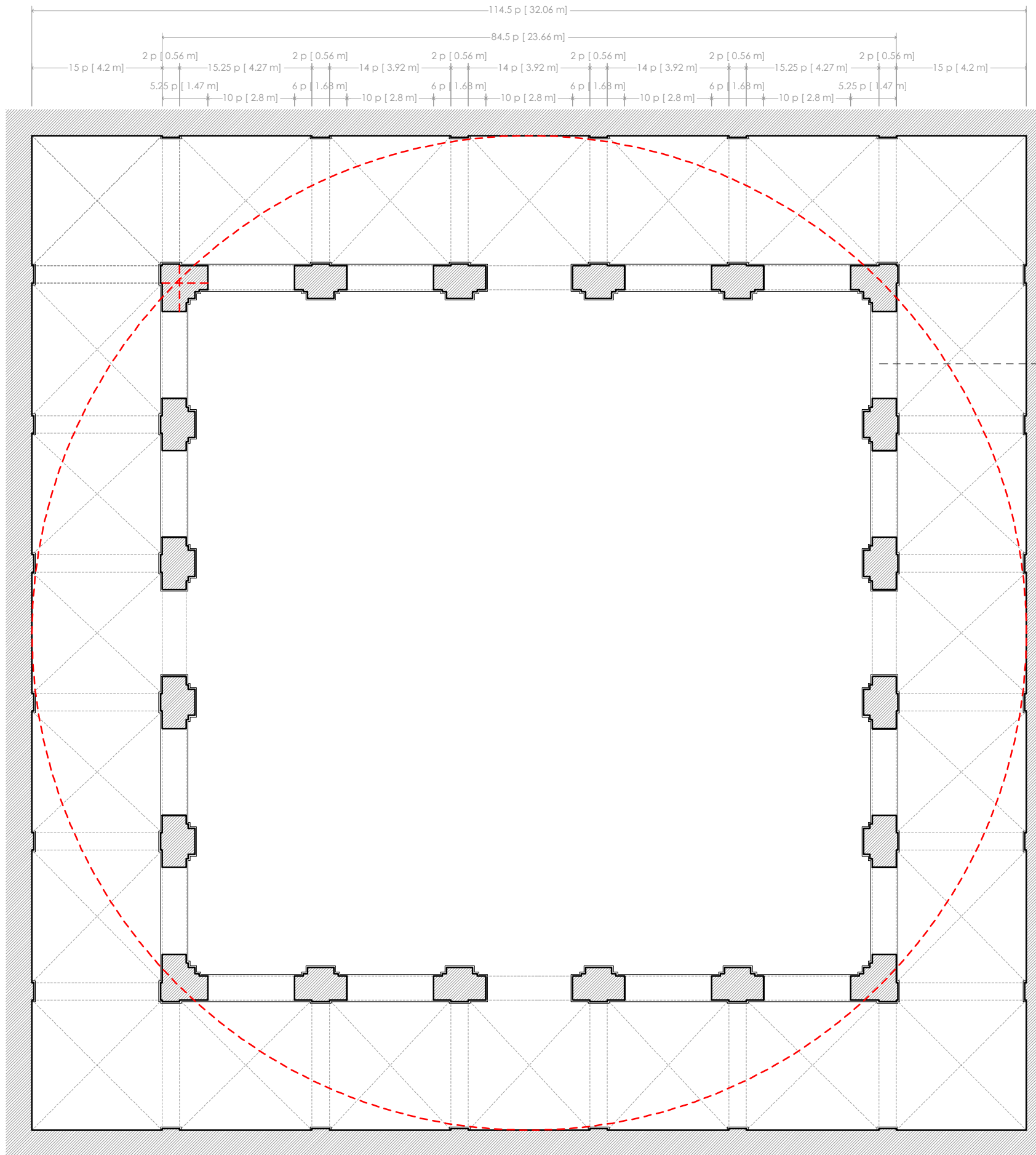

DETALLE CURVATURA ARCOS e:1/75

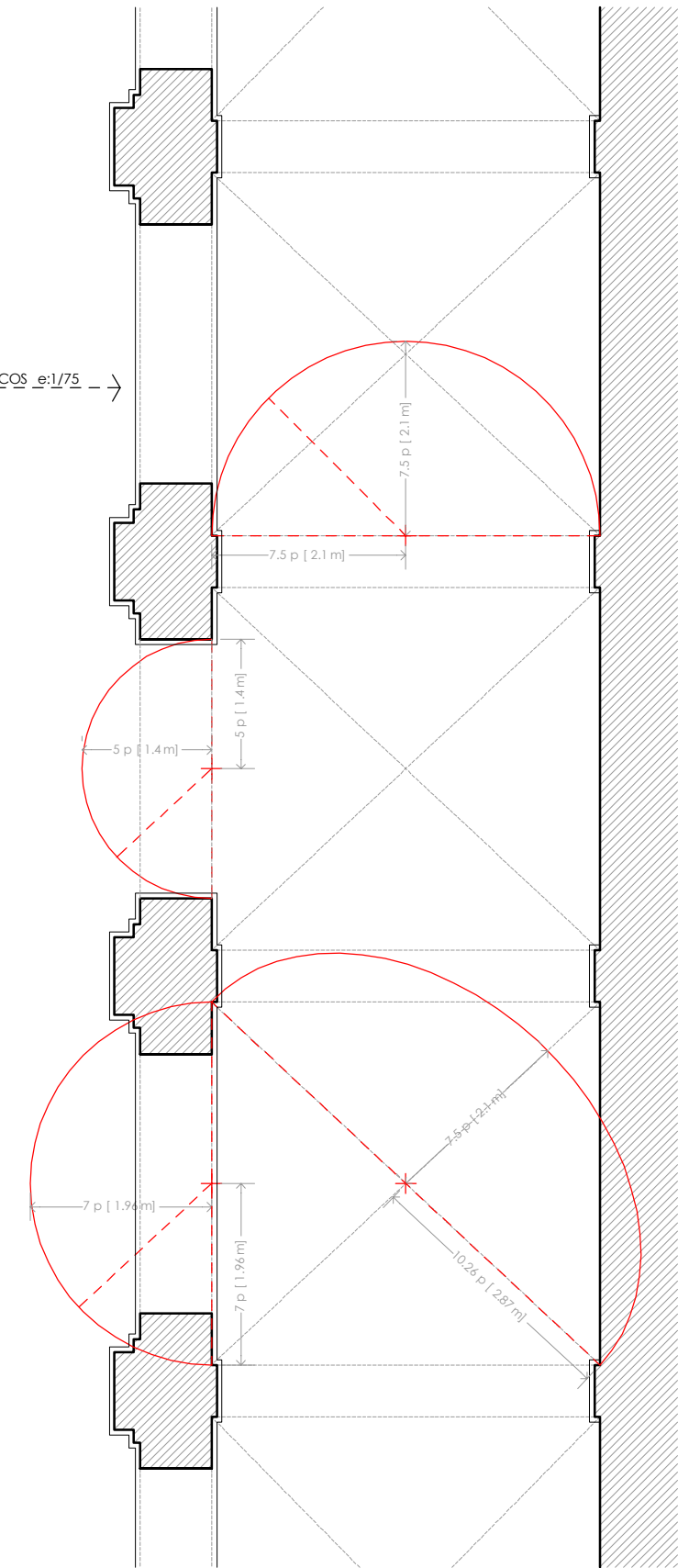

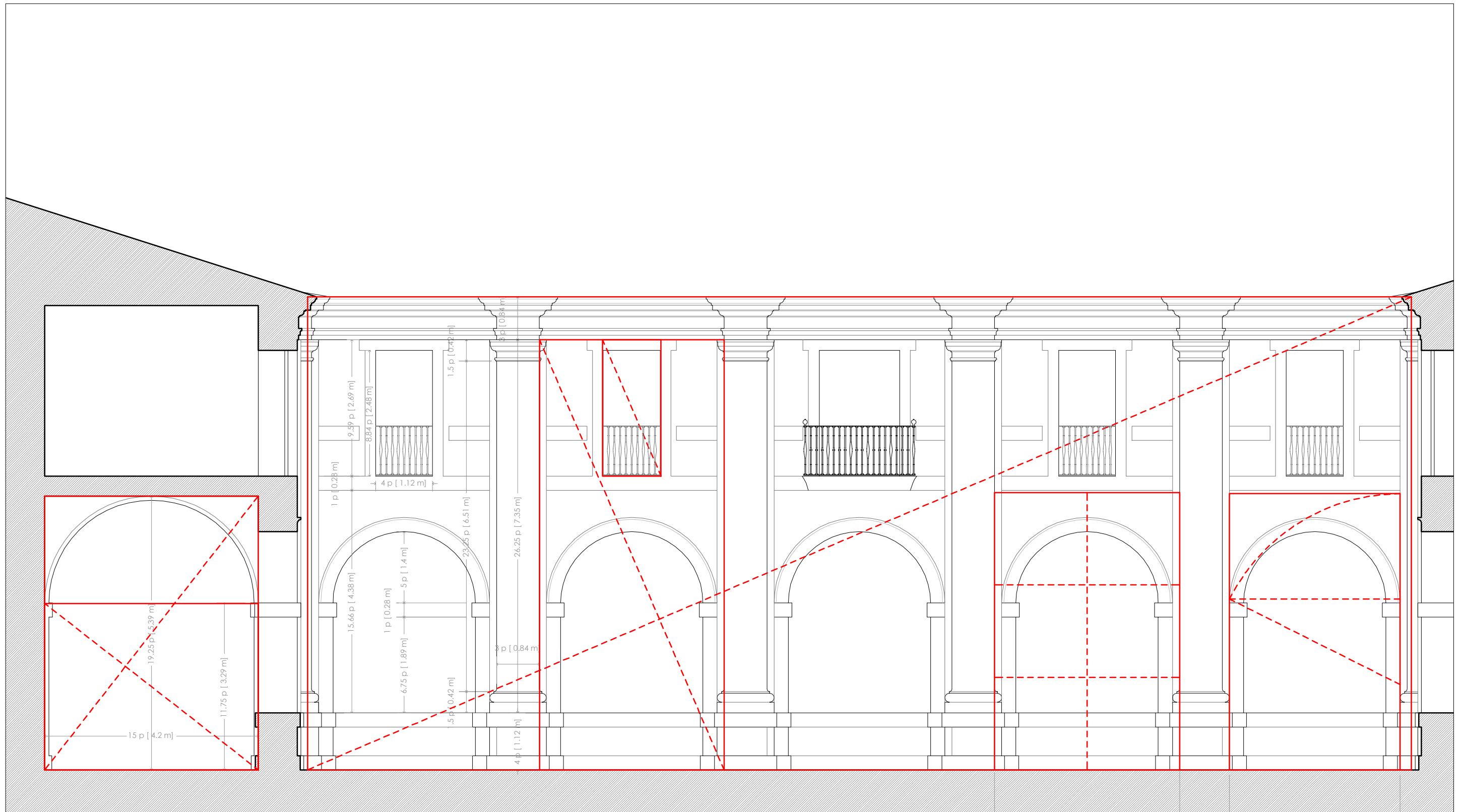

CORREDOR: PROPORCIÓN CERCANA A 5:4

LIENZO: PROPORCIÓN 7:3

13 p [ 3.64 m ]

12 p [ 3.36 m ]