



COLEGIO DEL CARDENAL proyecto de 1592



COLEGIO DEL CARDENAL modificación de 1594-1598



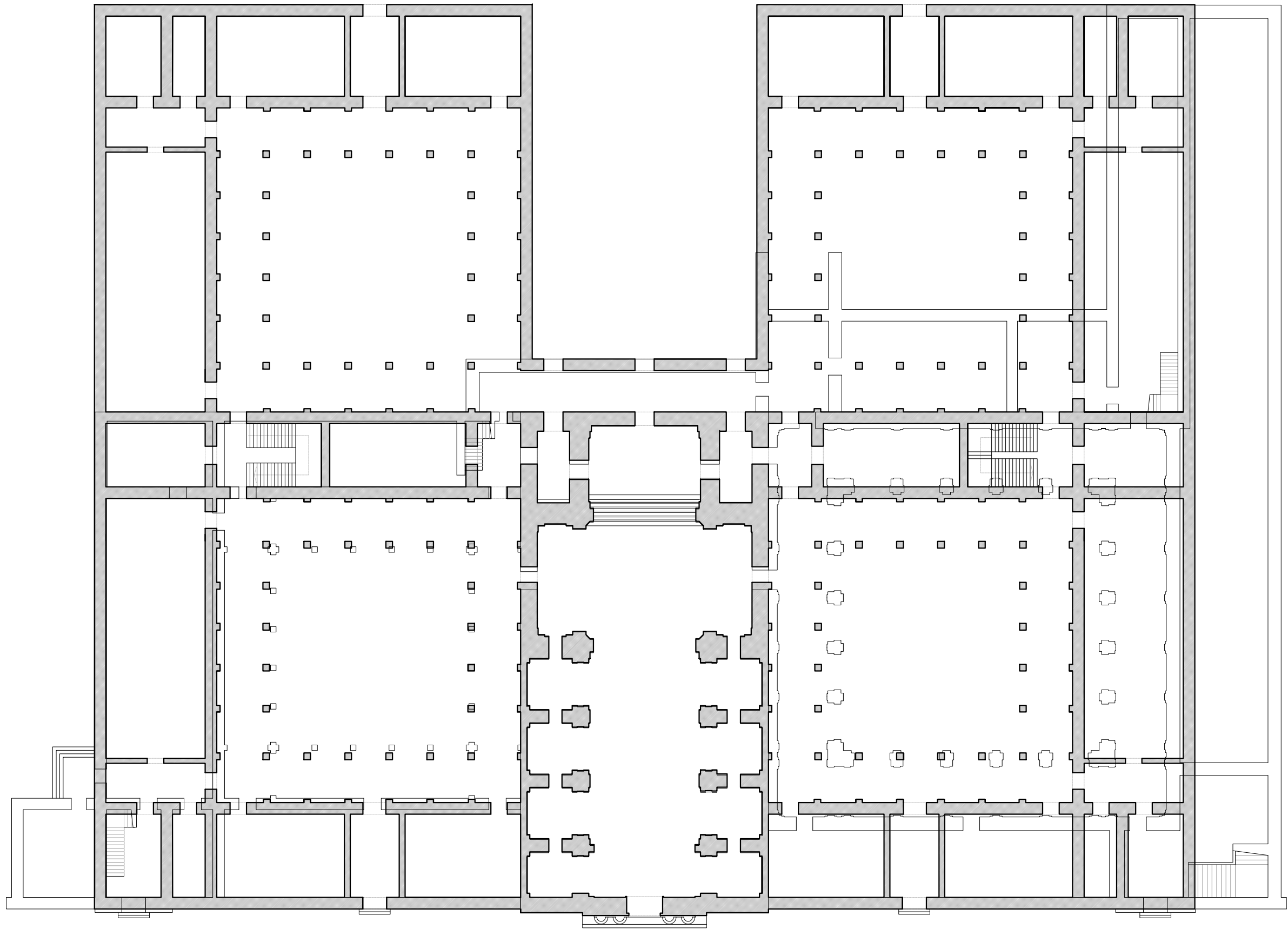

proyecto inicial 1592  
 construcción existente



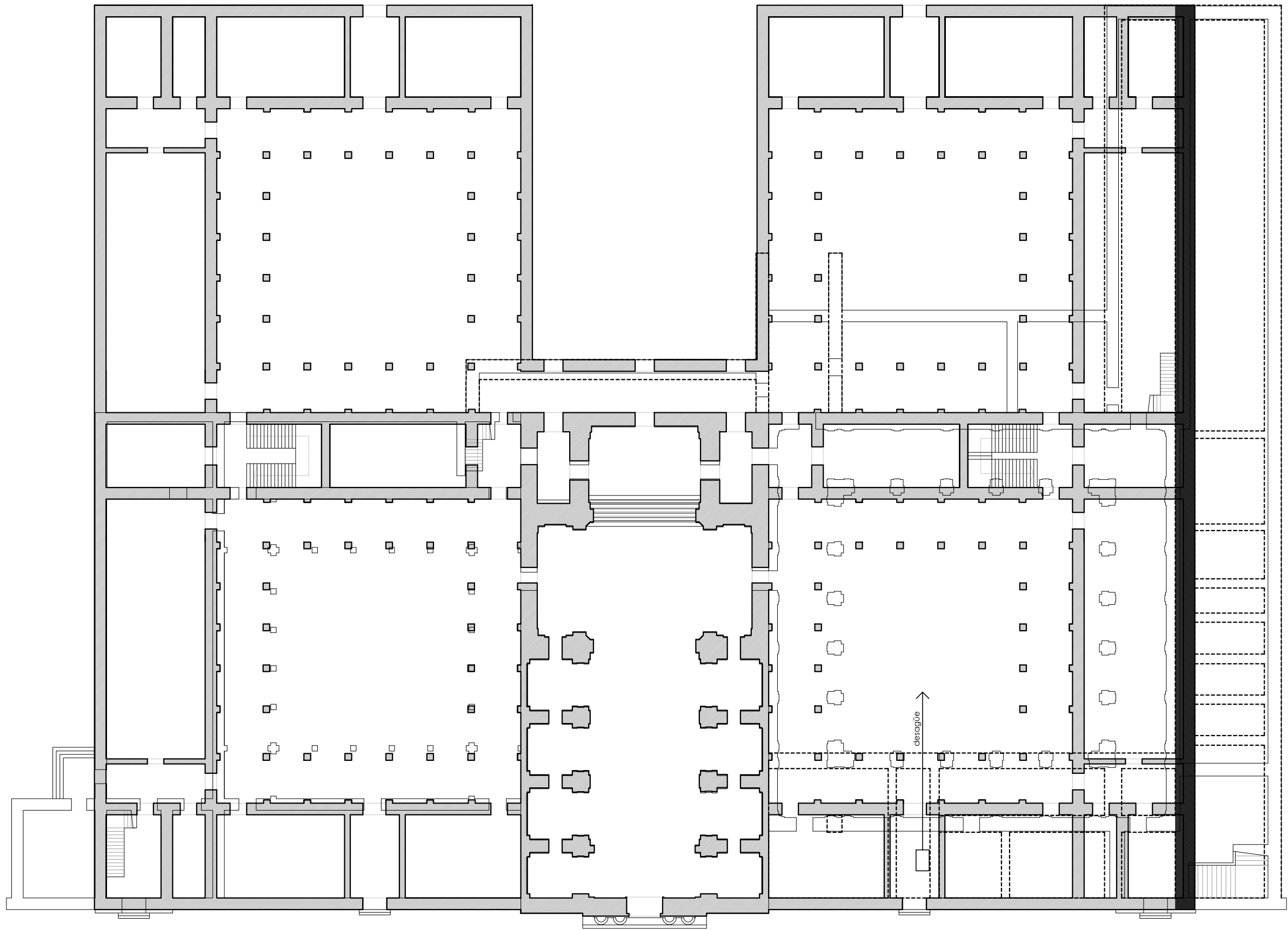

- proyecto inicial
- construcción existente
- cimentación proyecto inicial=existente
- cimentación existente



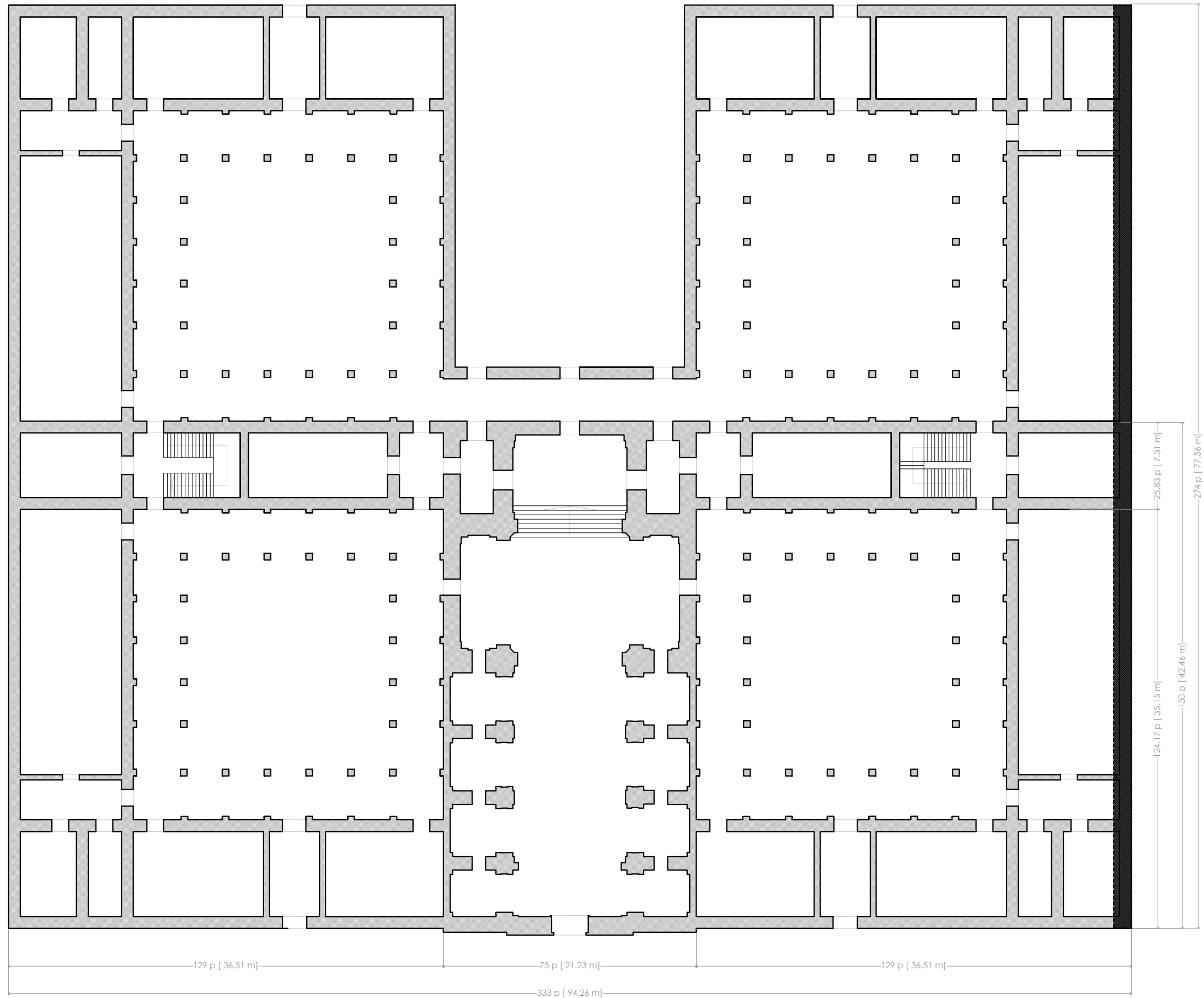

- 333 = 37 x 3<sup>2</sup>
- 150 = 5<sup>2</sup> x 3 x 2
- 124 = 31 x 2<sup>2</sup>
- 75 = 5<sup>2</sup> x 3
- 26 = 3 x 2<sup>3</sup>

proyecto inicial  
 cimentación proyecto inicial=existente

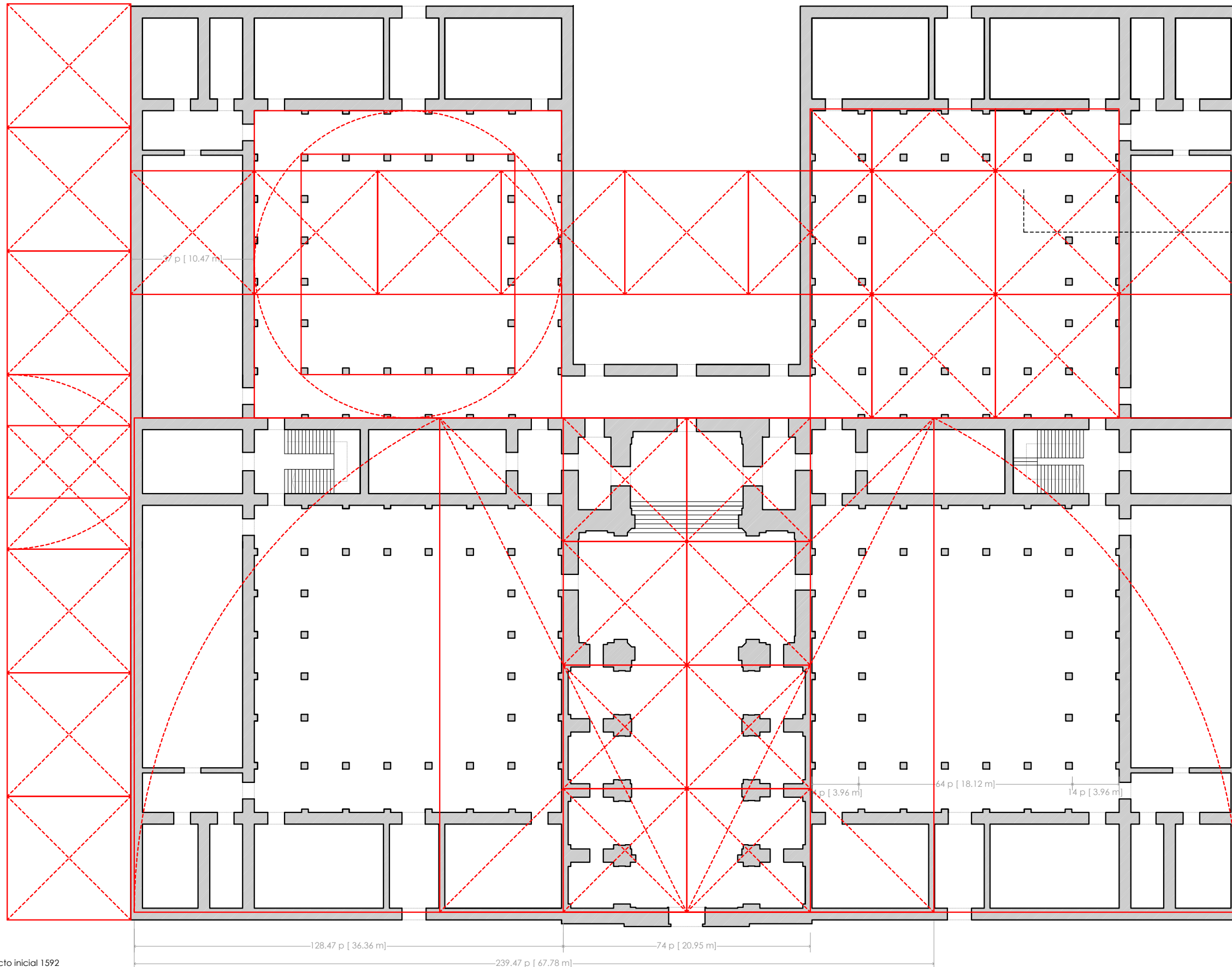

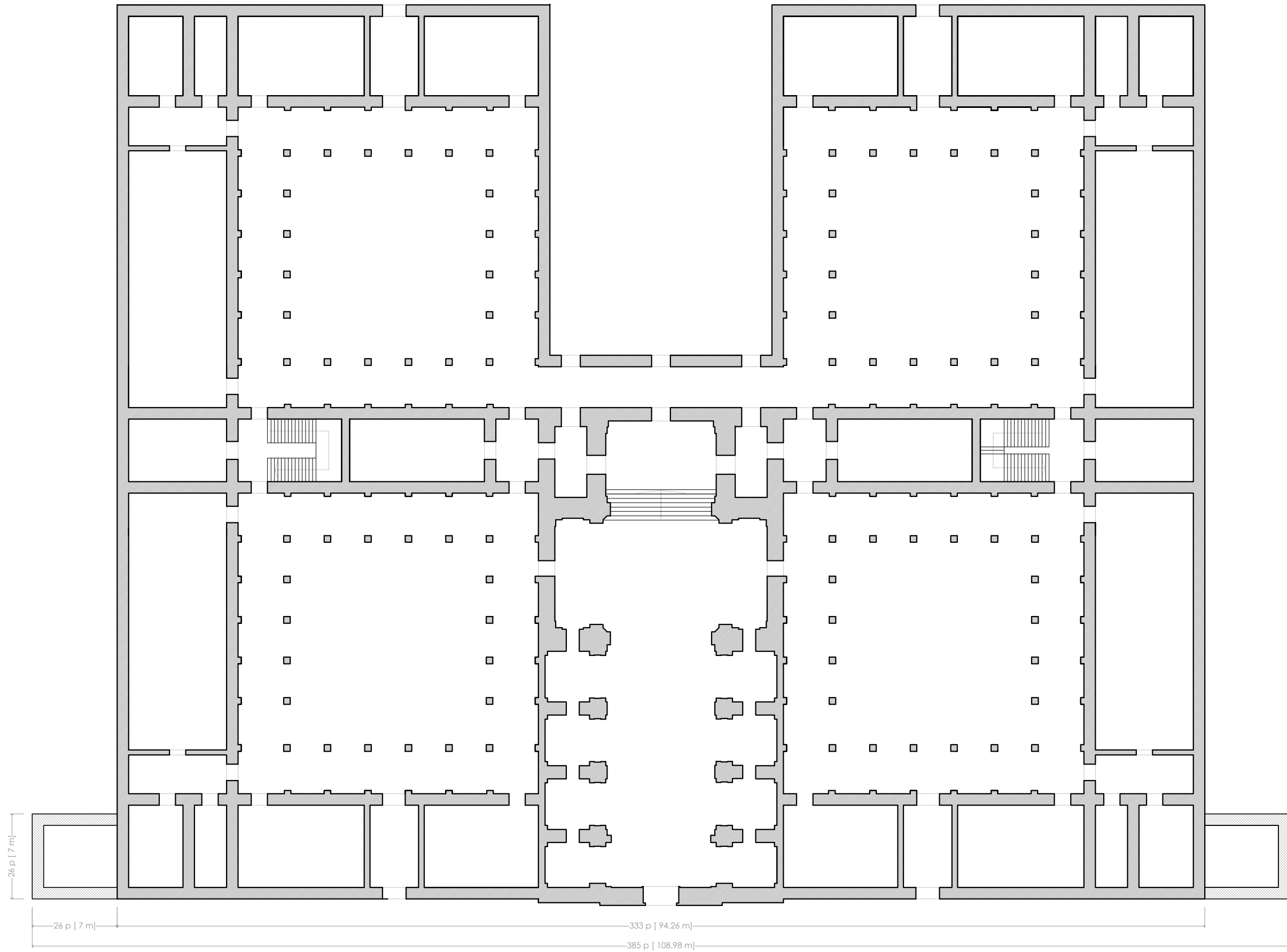

385 = 11 x 7 x 5  
 26 = 3 x 2<sup>3</sup>

proyecto inicial  
 proyecto de ampliación 1594

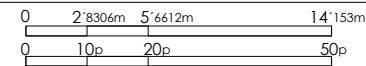

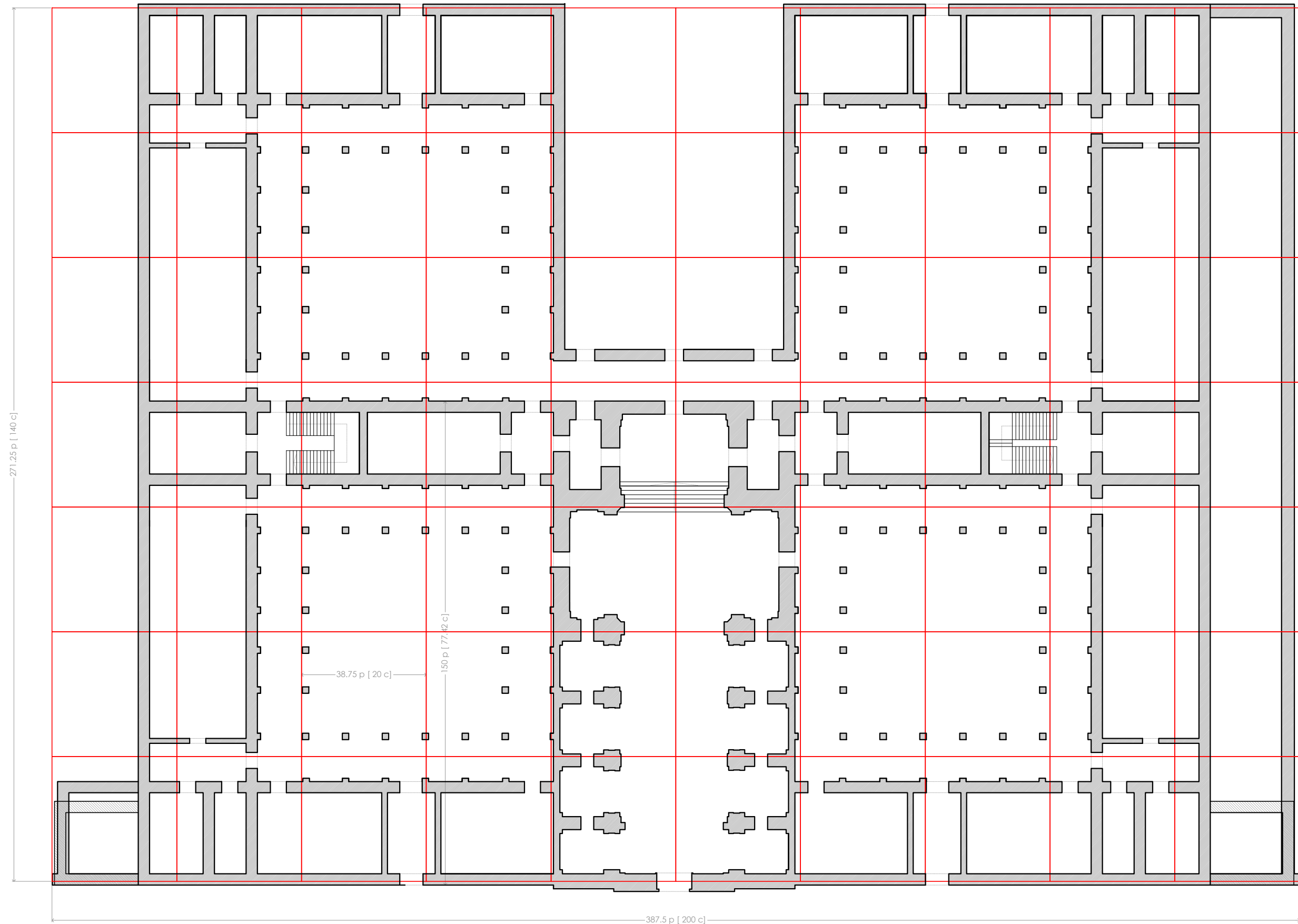

- proyecto de ampliación 1594
- hipótesis construcción final Tolosa

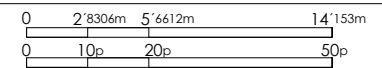



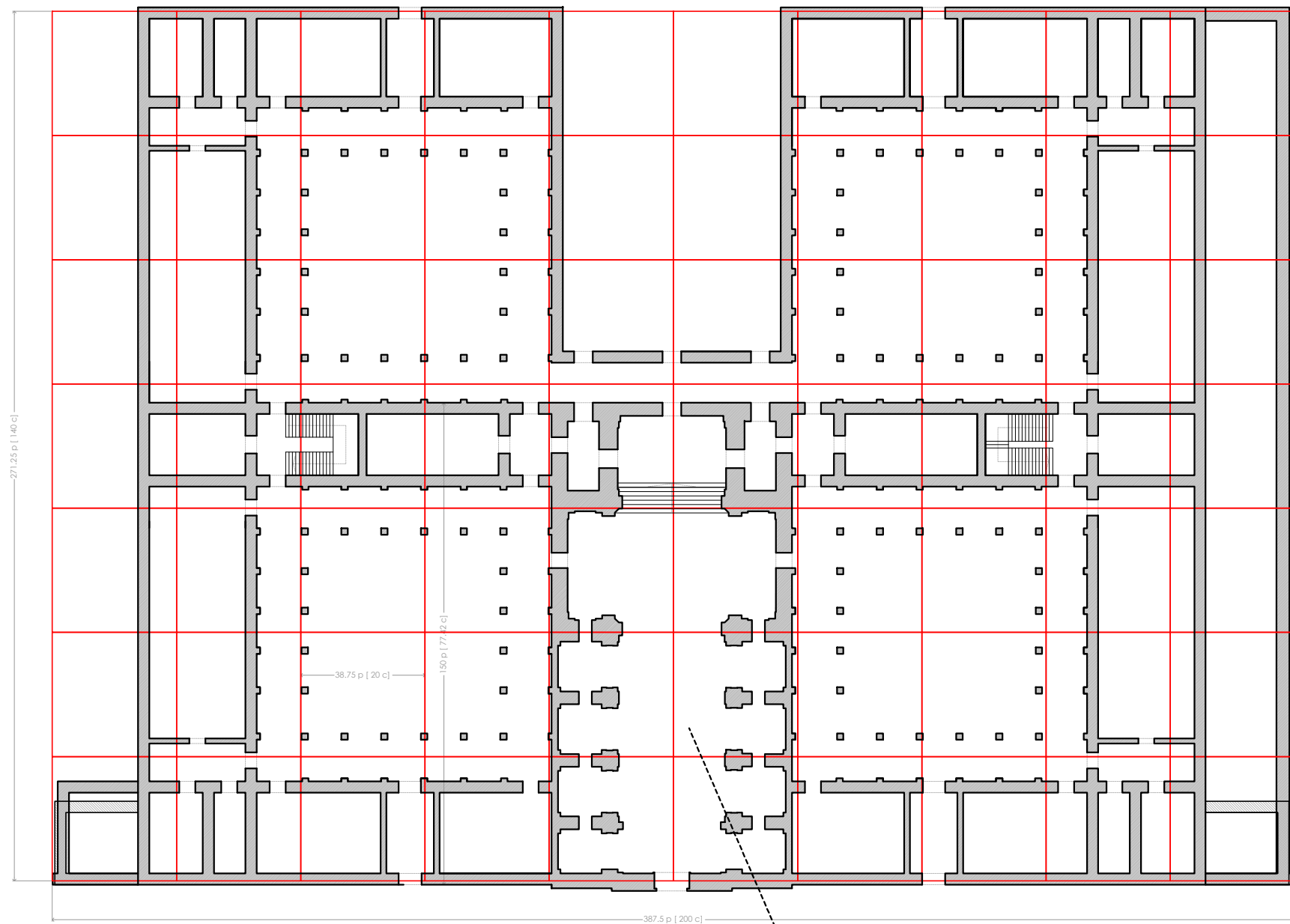

DETALLE DE PILARES IGLESIA  
ajuste métrico de codos a pies e: 1/100

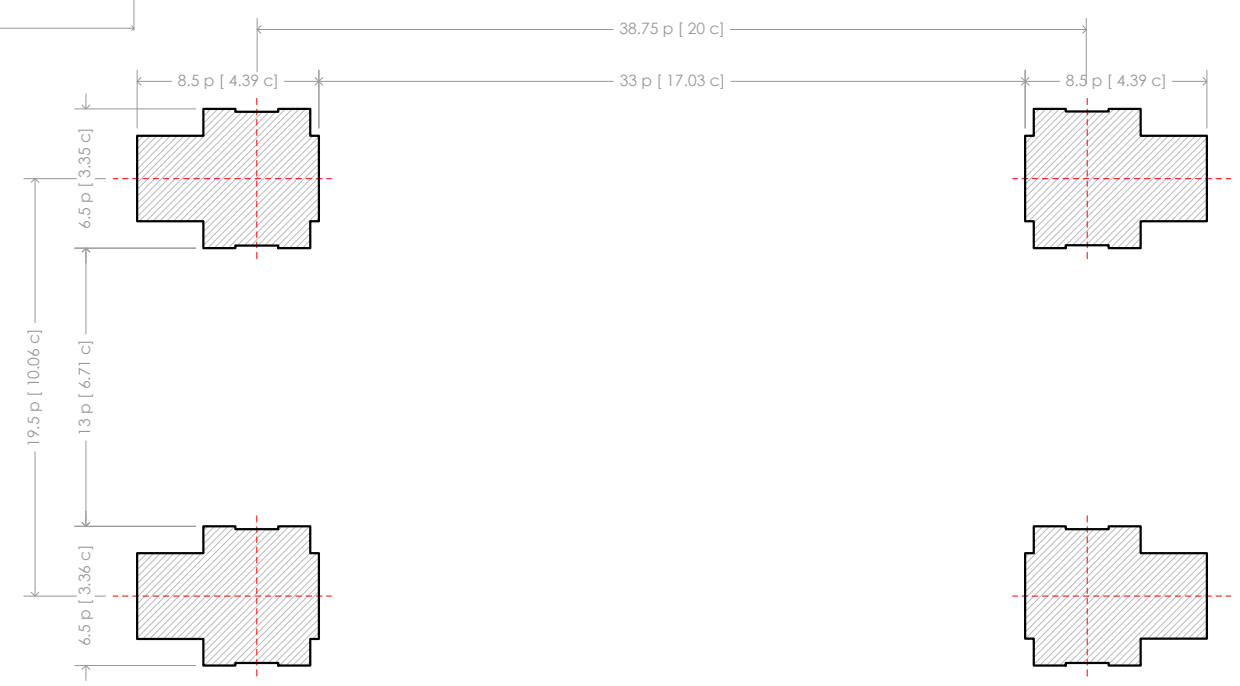

proyecto de ampliación 1594  
 hipótesis construcción final Tolosa

e: 1/500	0	5'484m	10'968m	21'937m
1pie: 28.306cm	0	19'375p	38'75p	77'50p
1codo: 54.842cm	0	10codos	20codos	40codos

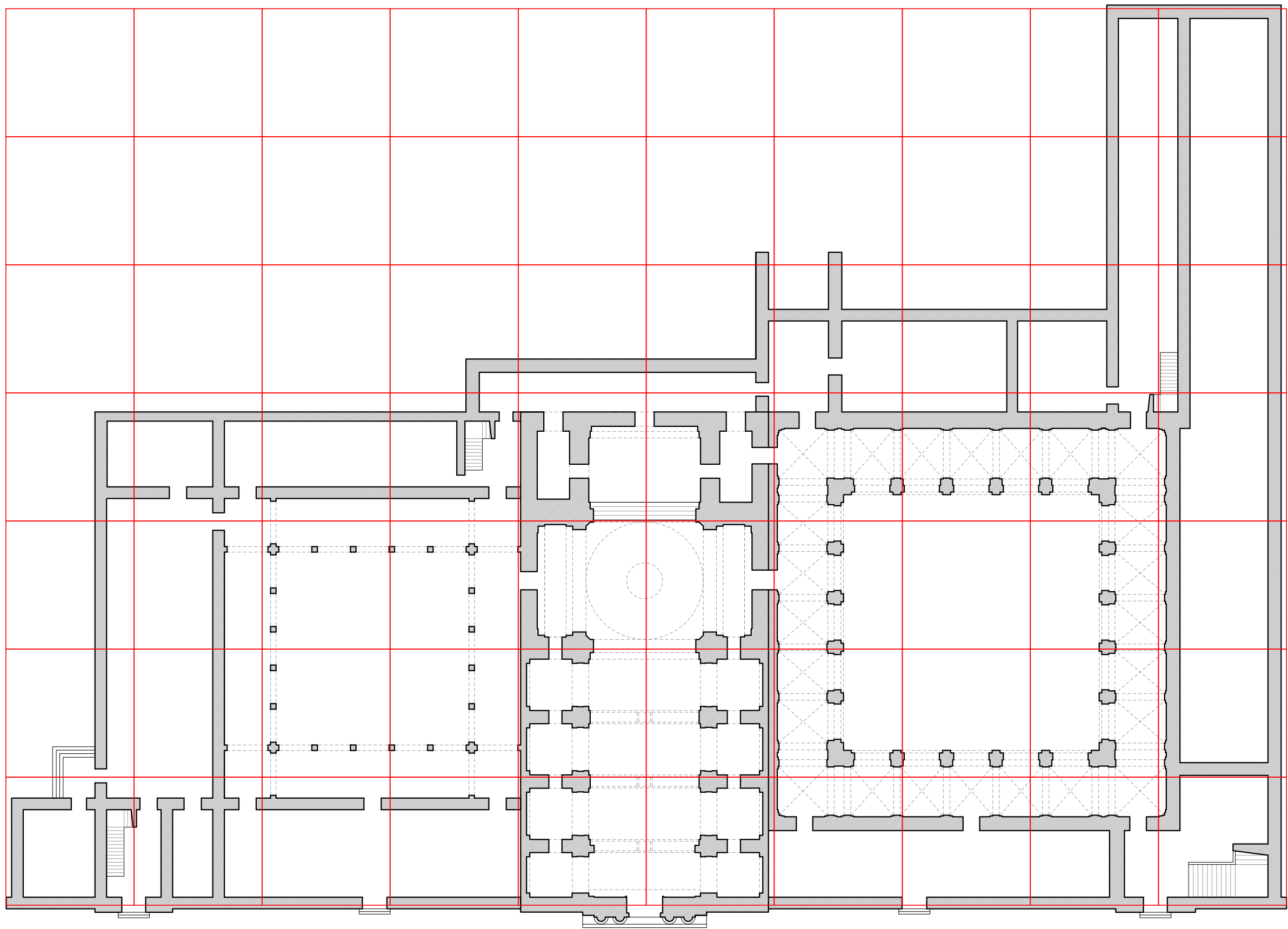

construcción existente actualmente  
 trama modular de 20 codos hebreos



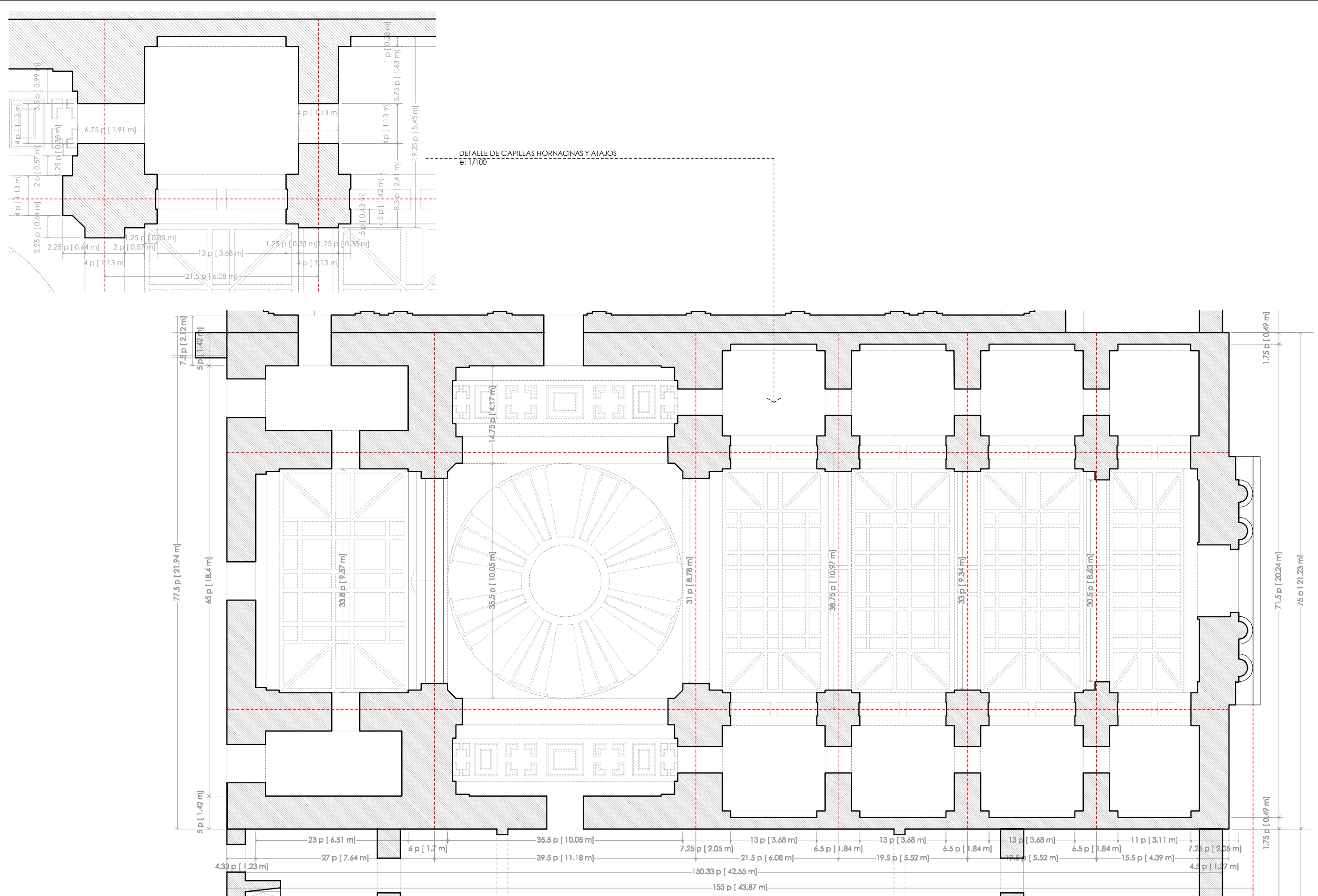

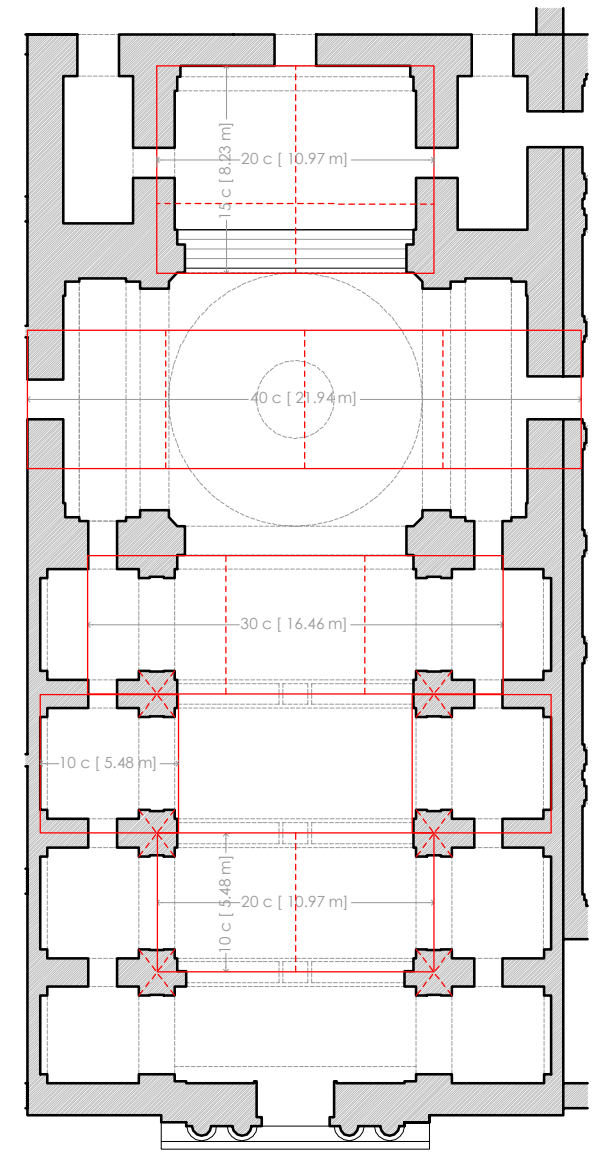
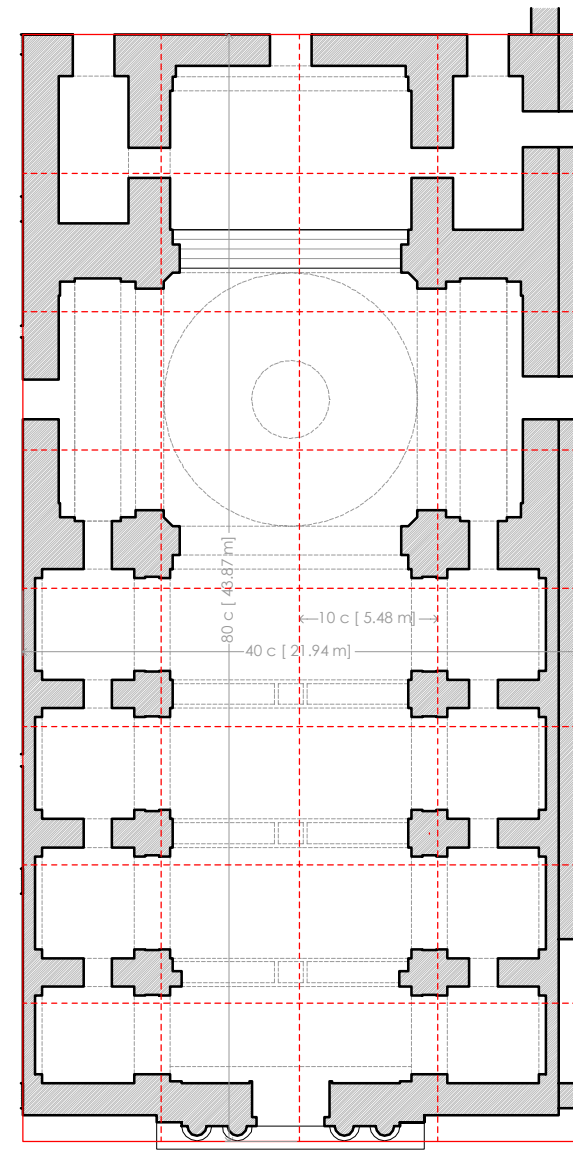
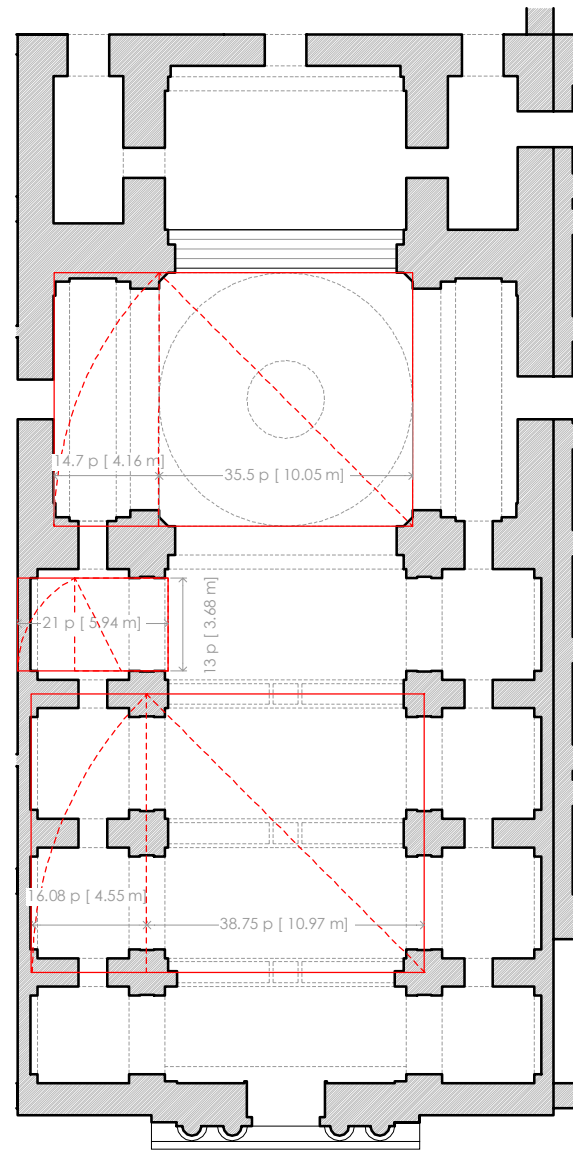
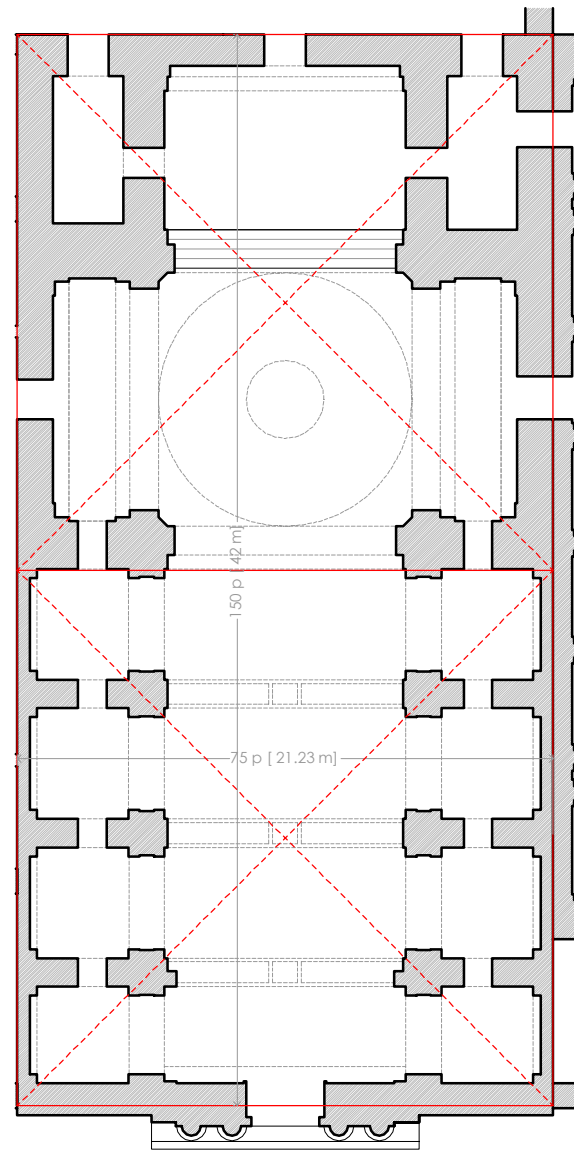

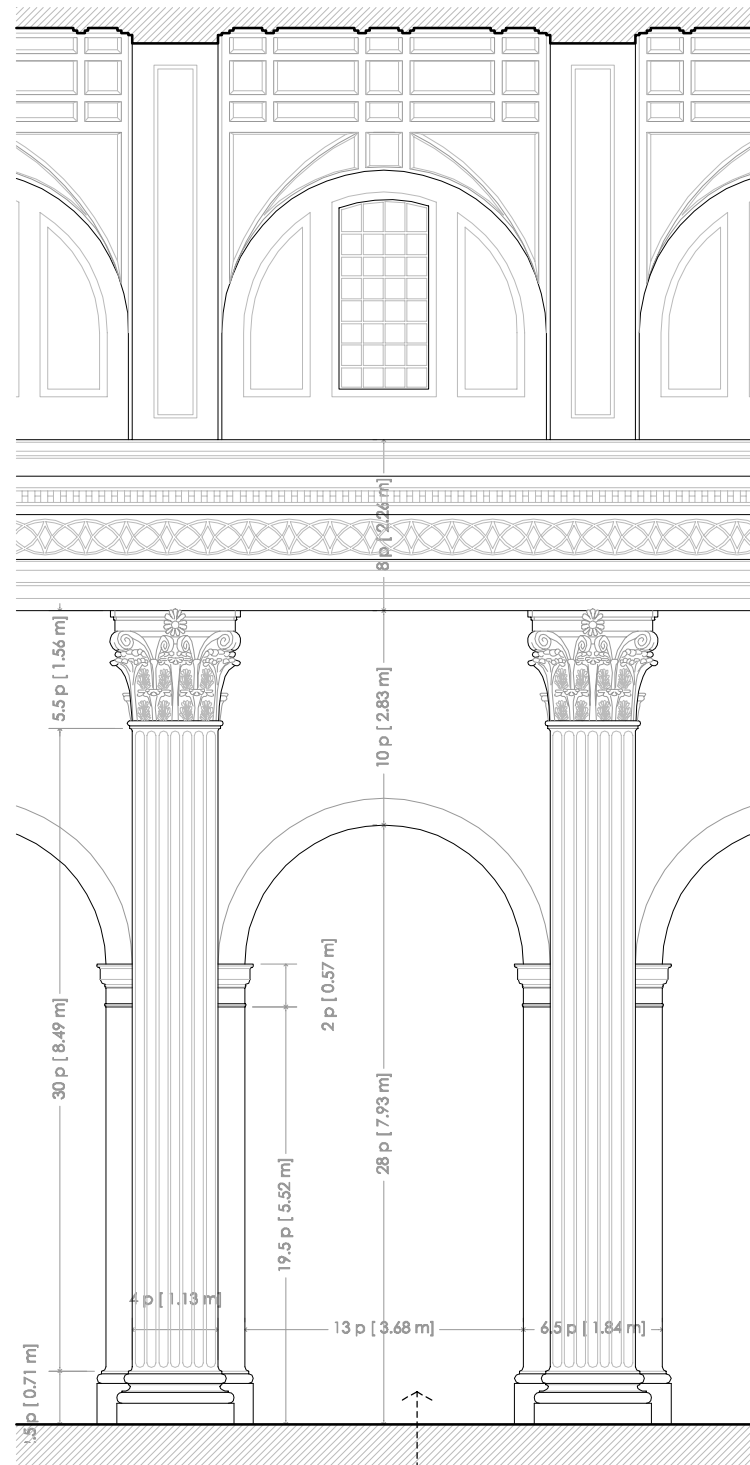

DETALLE DE ALZADO  
e: 1/100





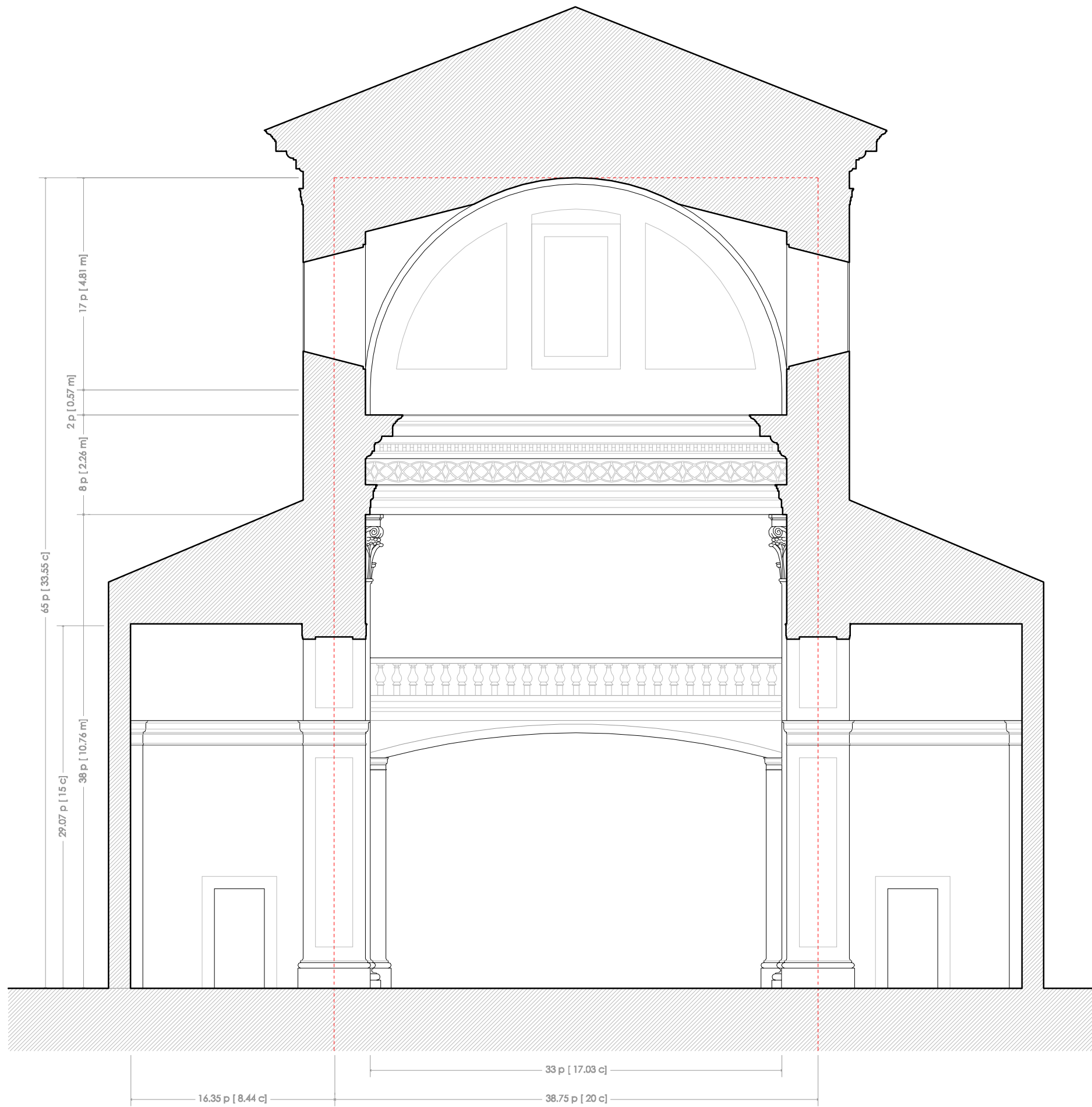

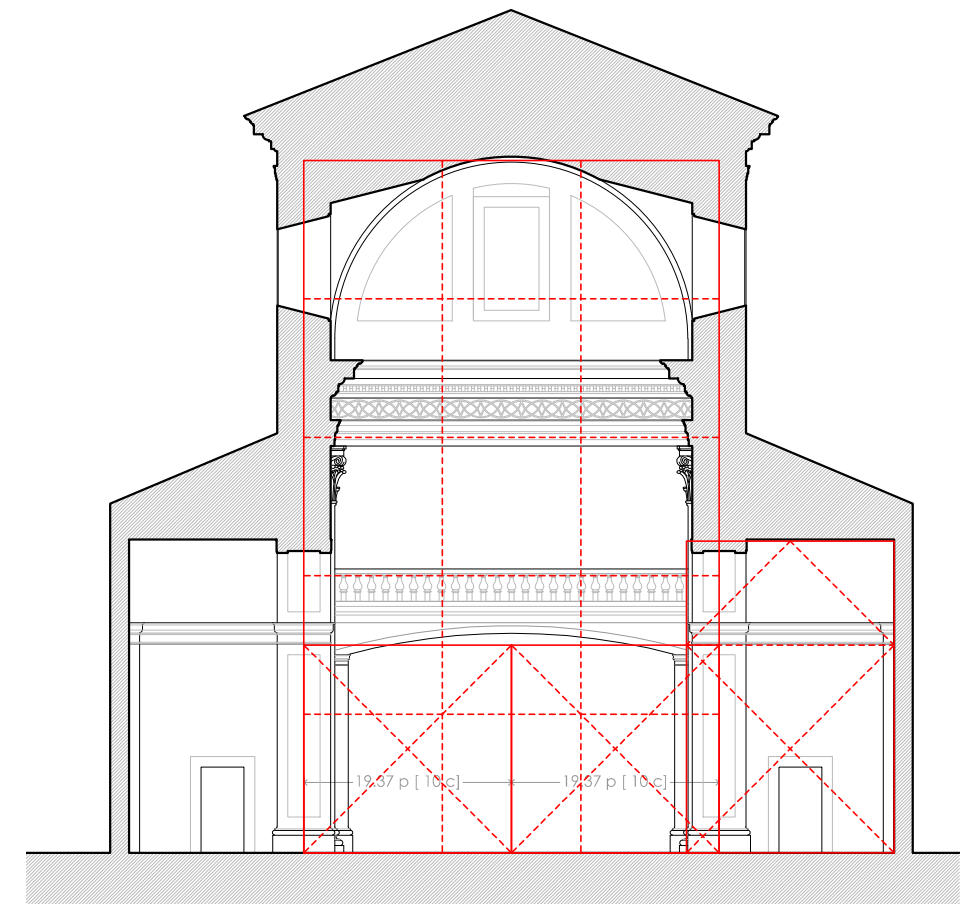
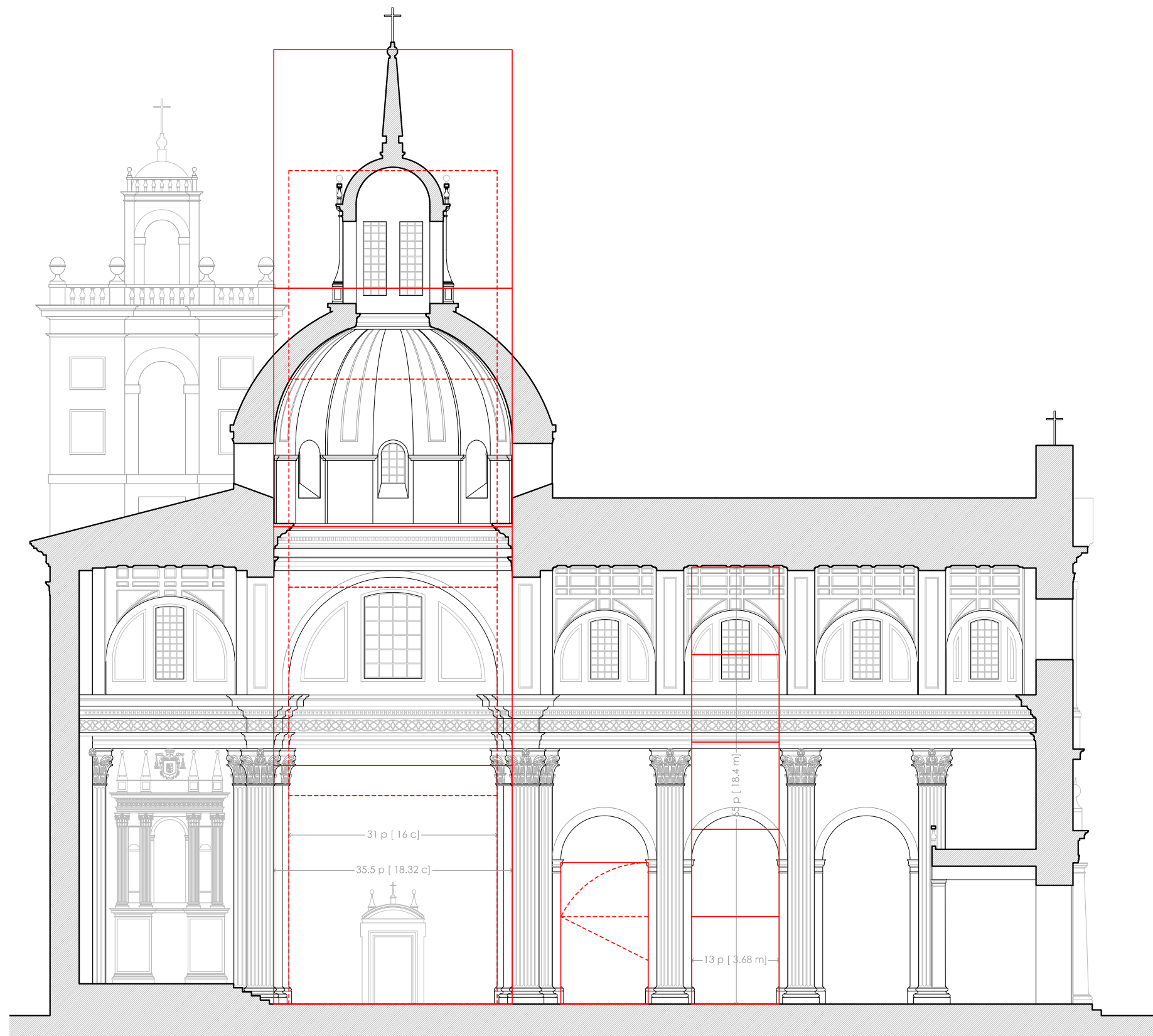

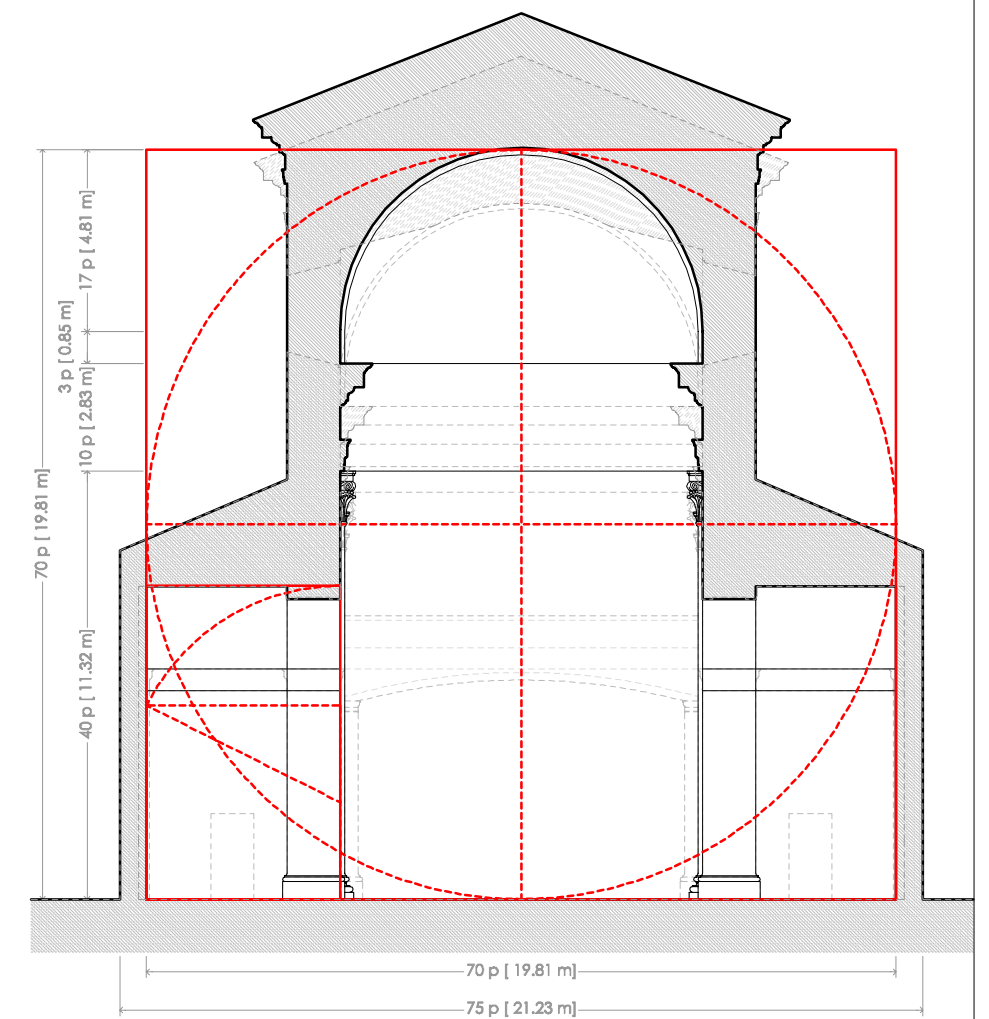
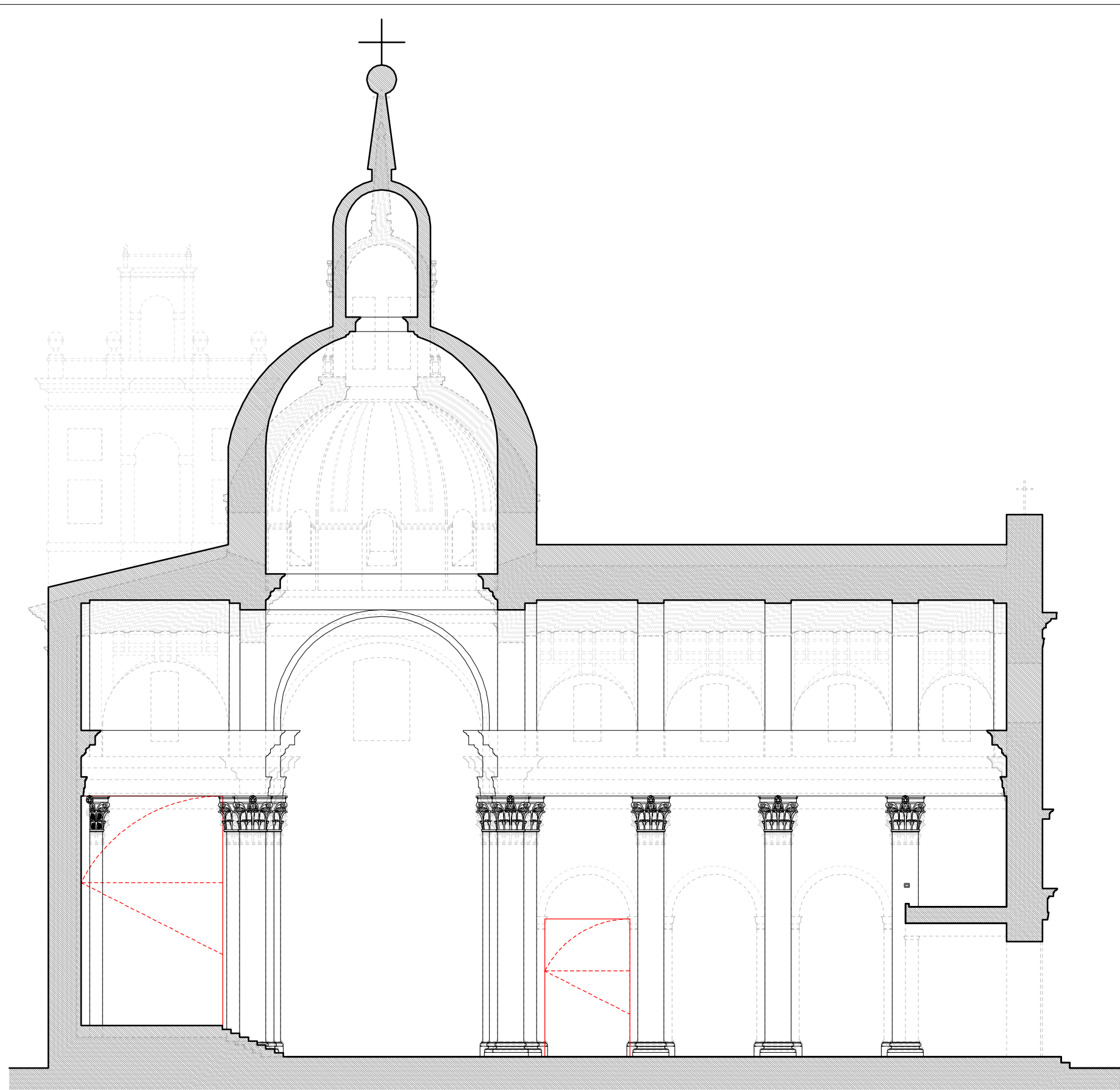

Andrés Ruiz  
 construido

TESIS DOCTORAL UDC. TÍTULO: **PROCESO METODOLÓGICO Y COMPOSITIVO DEL RENACIMIENTO EN GALICIA. 1499-1657**  
 AUTOR: D. VICTOR GRANDE NIETO      DIRECTOR: DR. MERINO DE CÁCERES      CODIRECTOR: DR. SORALUCE BLOND

**COLEGIO DEL CARDENAL**  
 Monforte de Lemos

HIPÓTESIS PROYECTO IGLESIA: ANDRÉS RUIZ  
 ANÁLISIS

e: 1/200	0	5'484m	10'968m
1pie: 28.306cm	0	19'375p	38'75p
1codo: 54.842cm	0	10codos	20codos



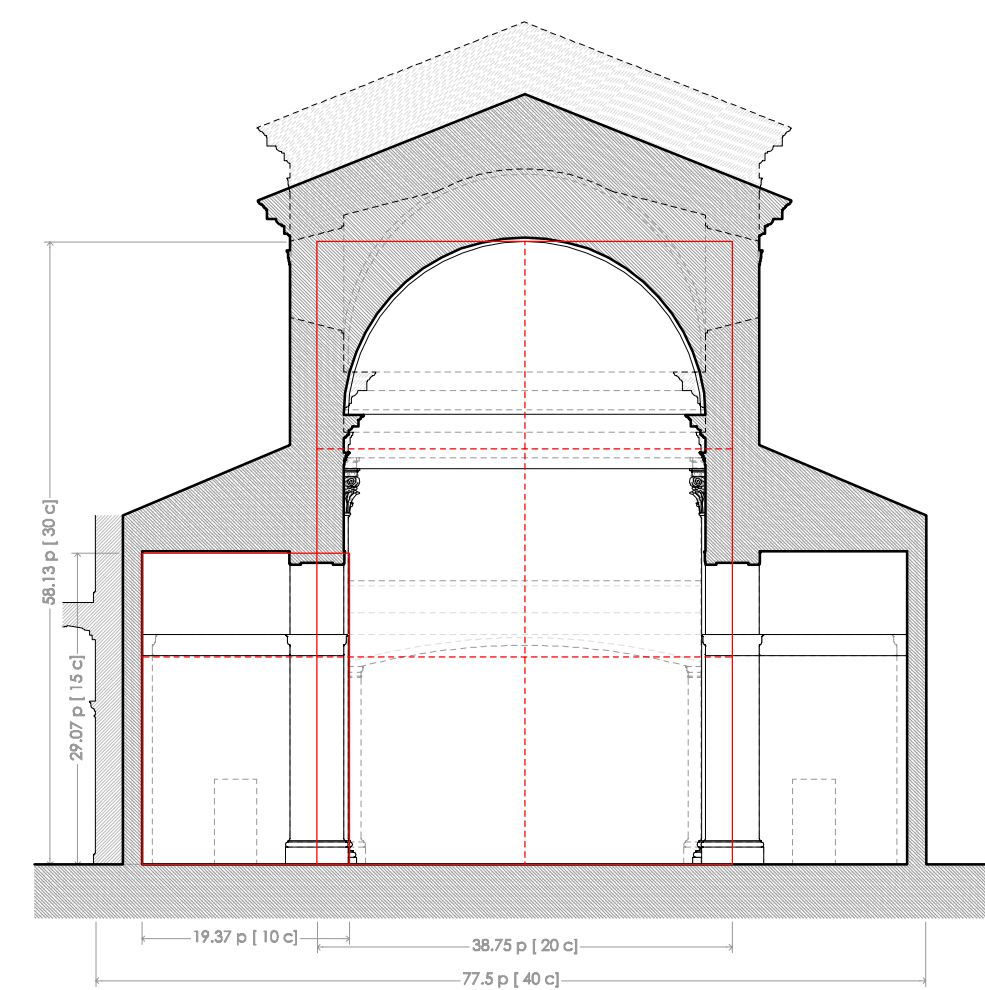

Juan de Tolosa  
 construido

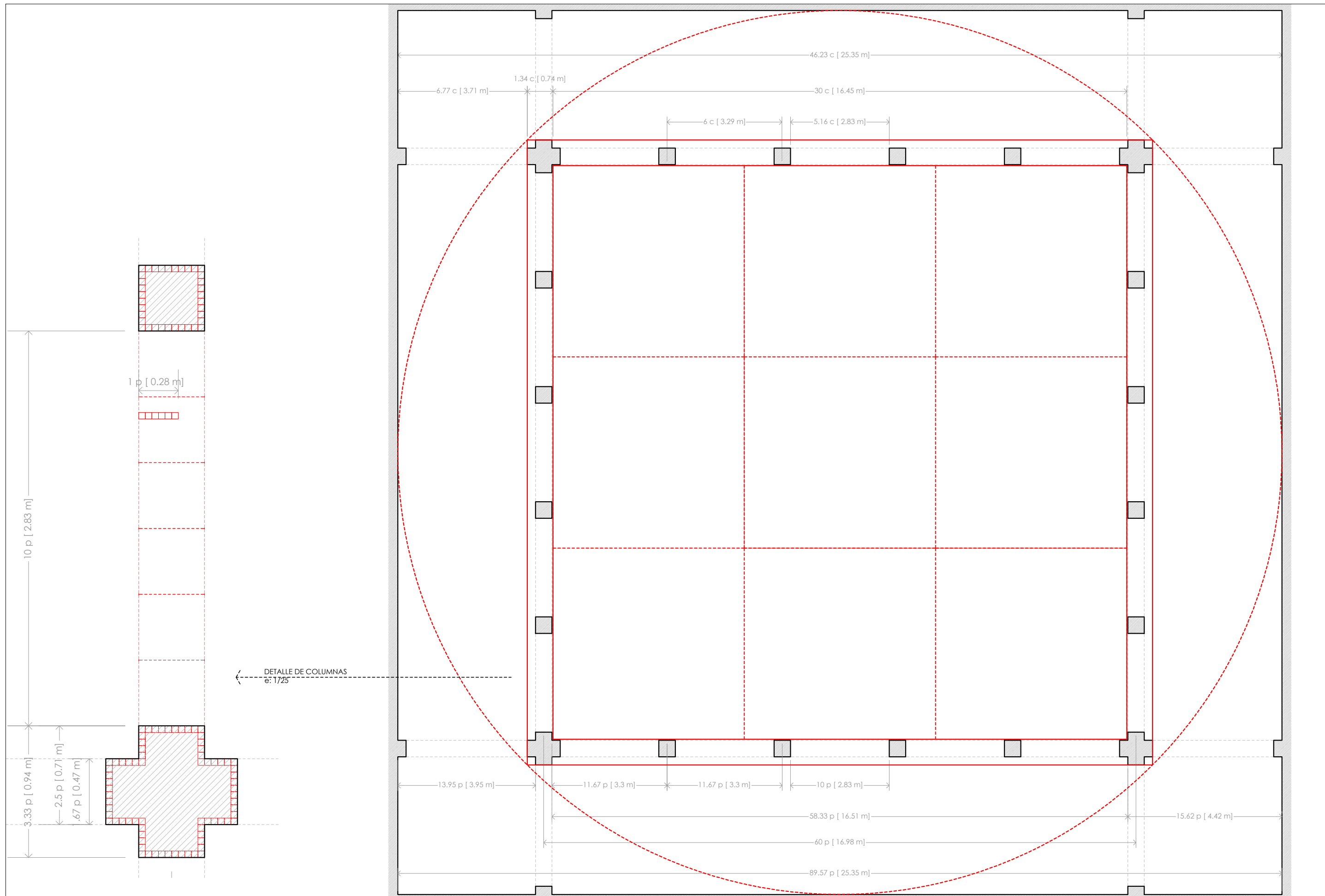

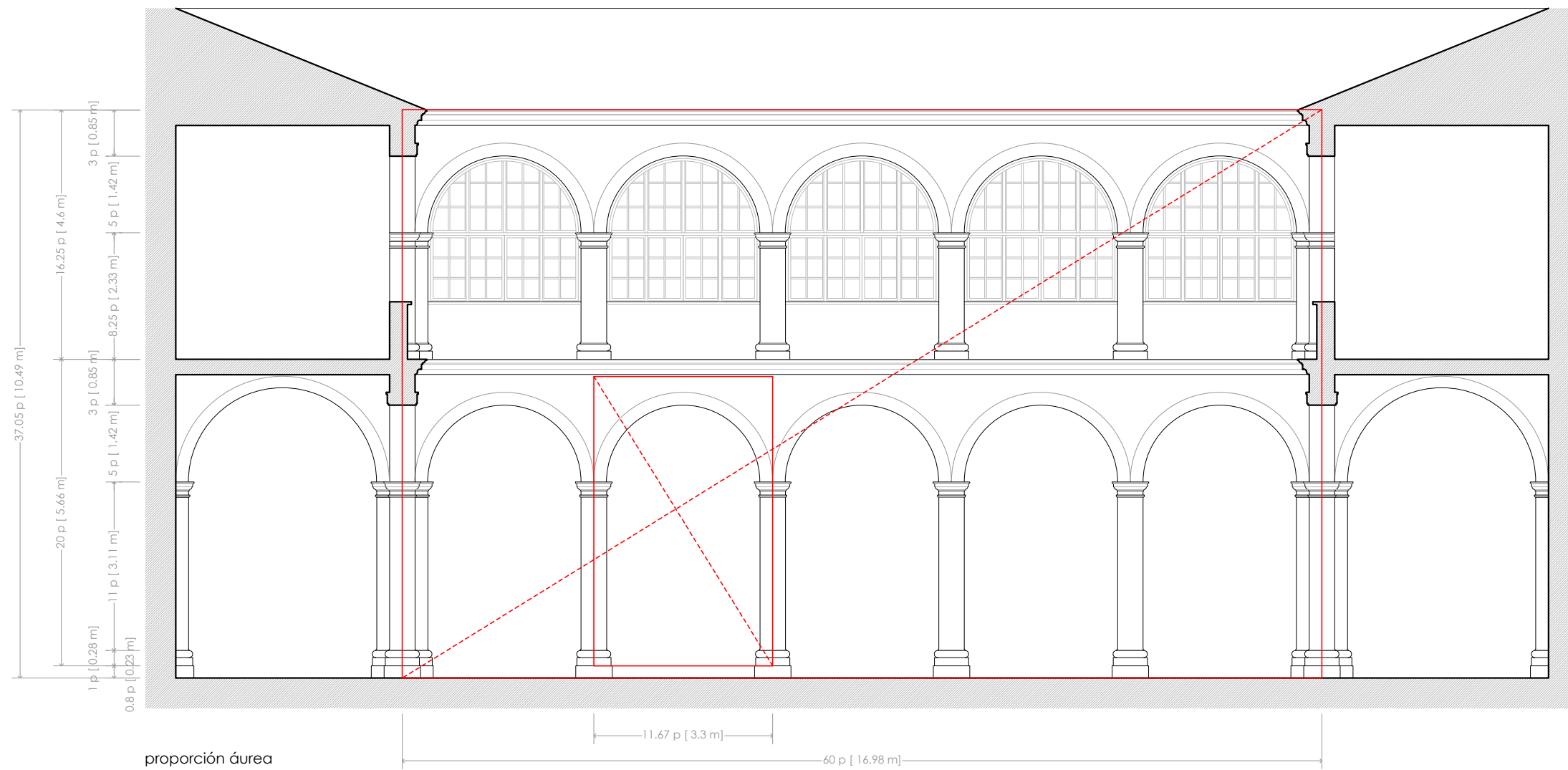



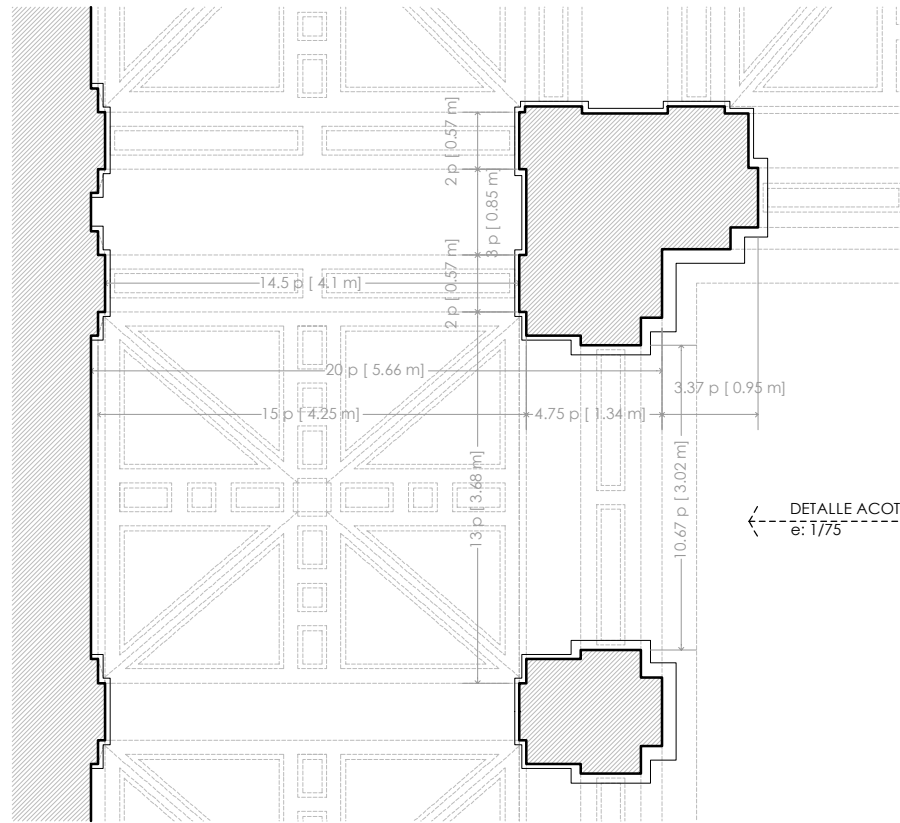

DETALLE ACOTACIÓN  
 e: 1/75

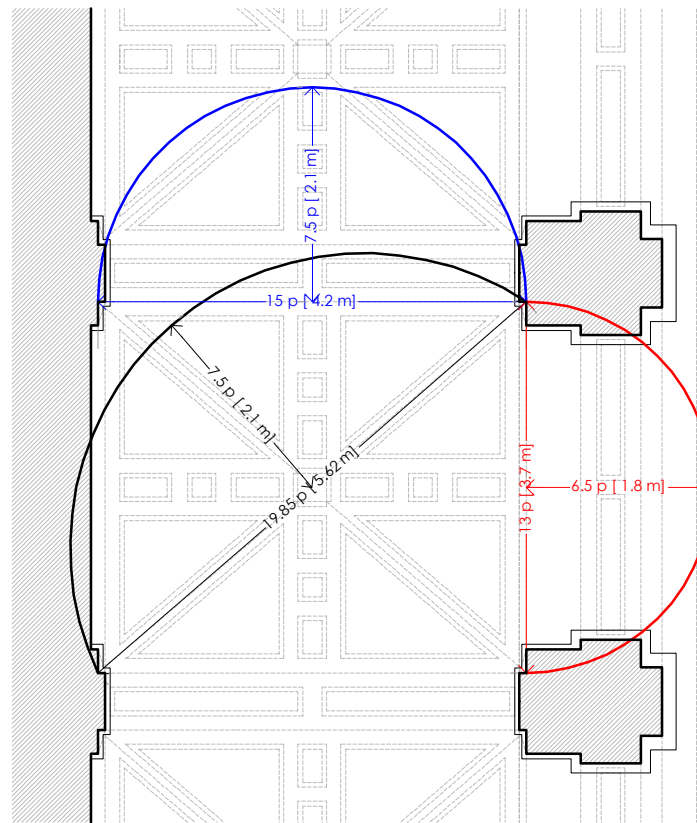

DETALLE BÓVEDAS  
 e: 1/75

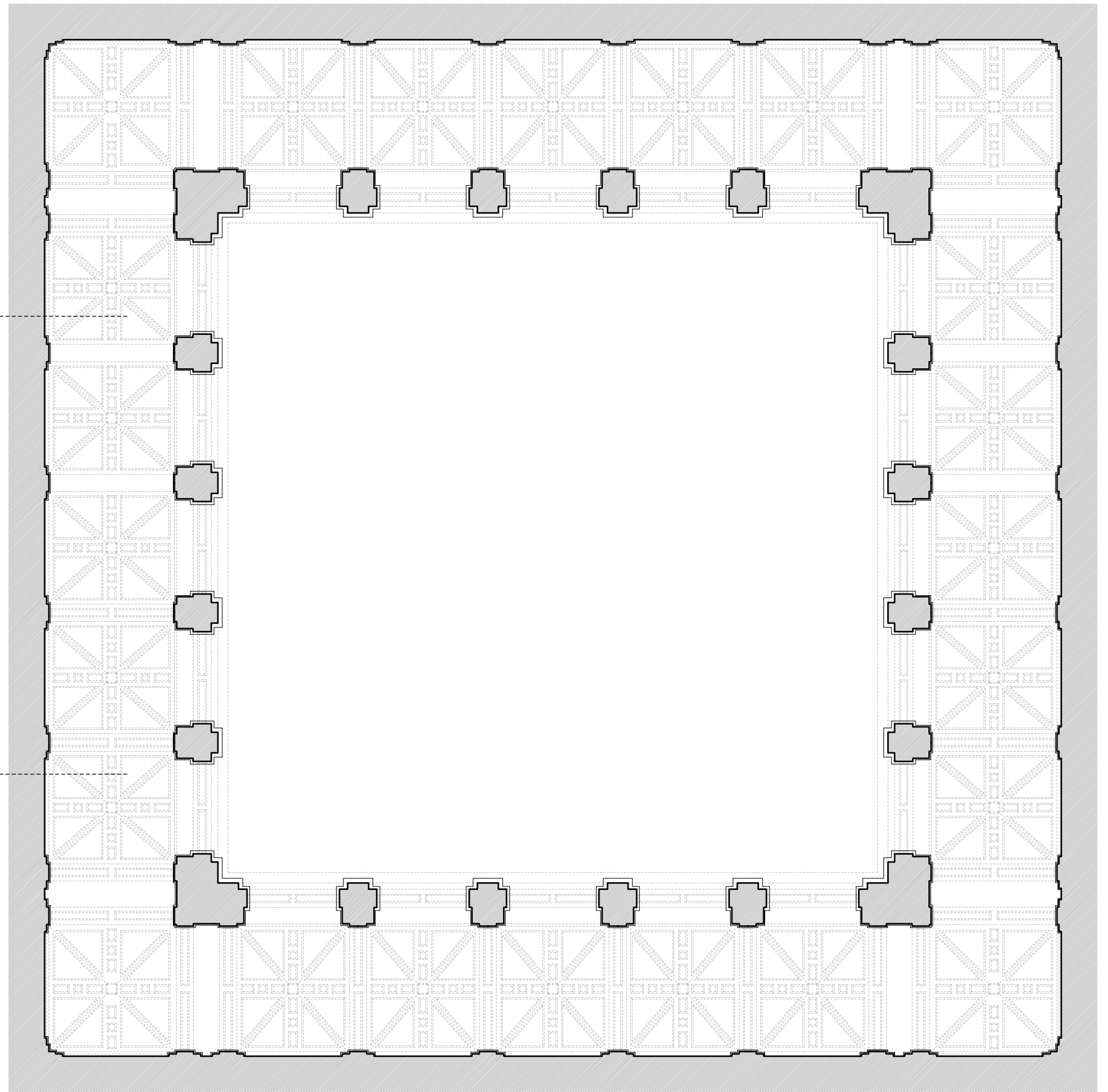

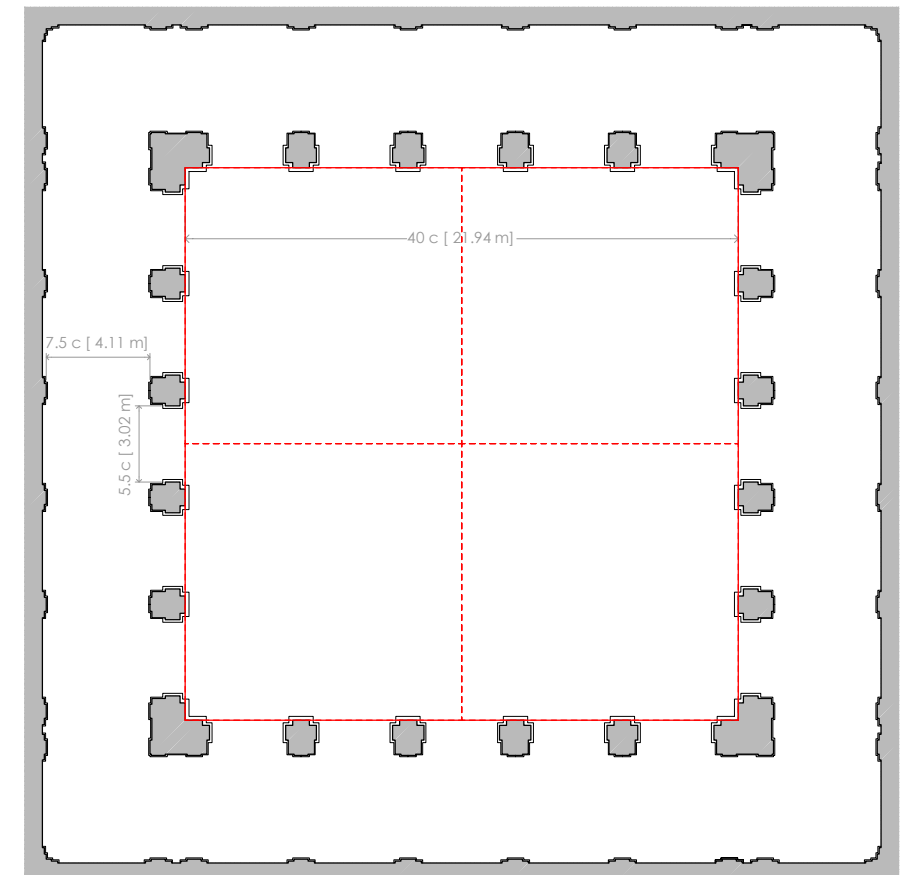
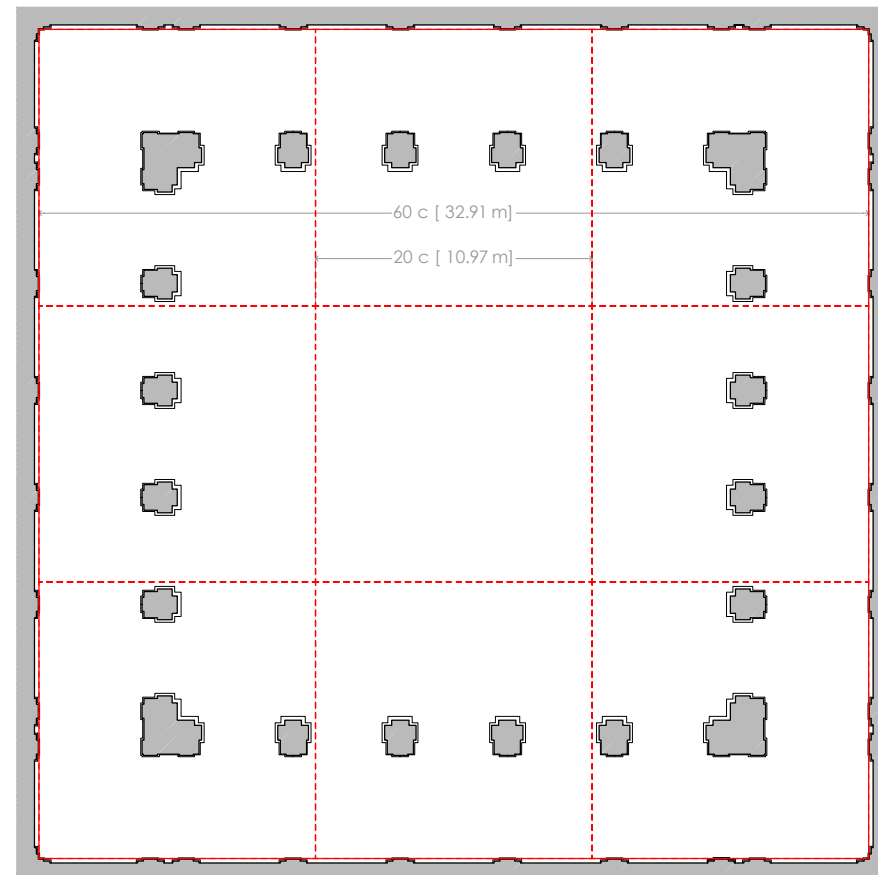
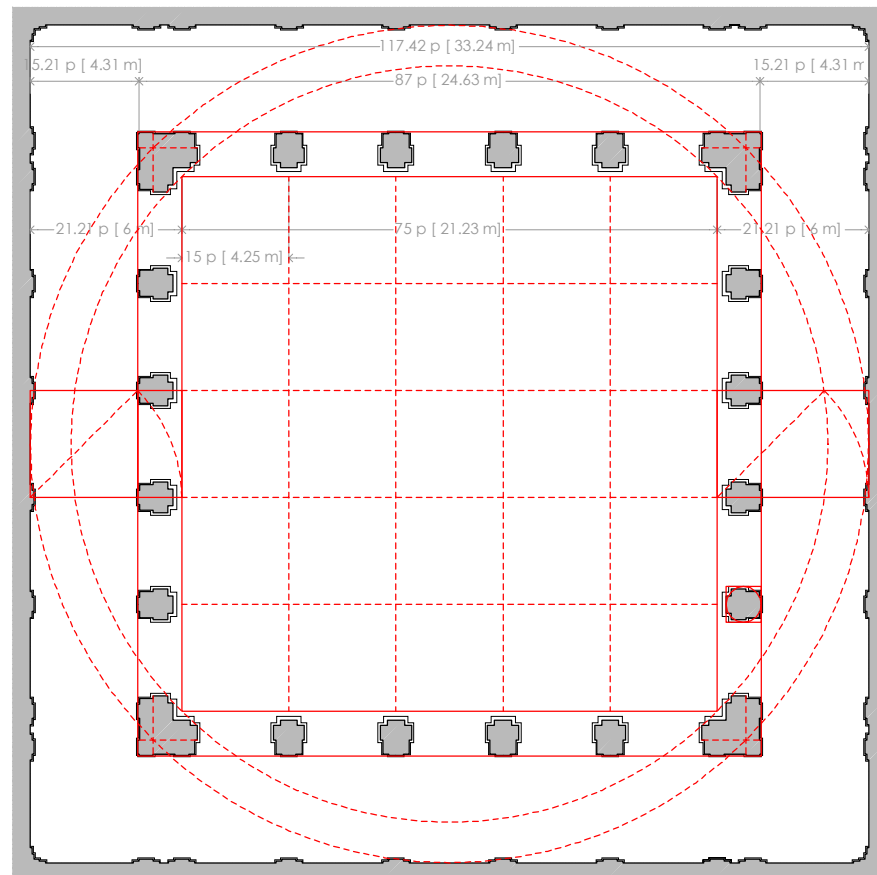

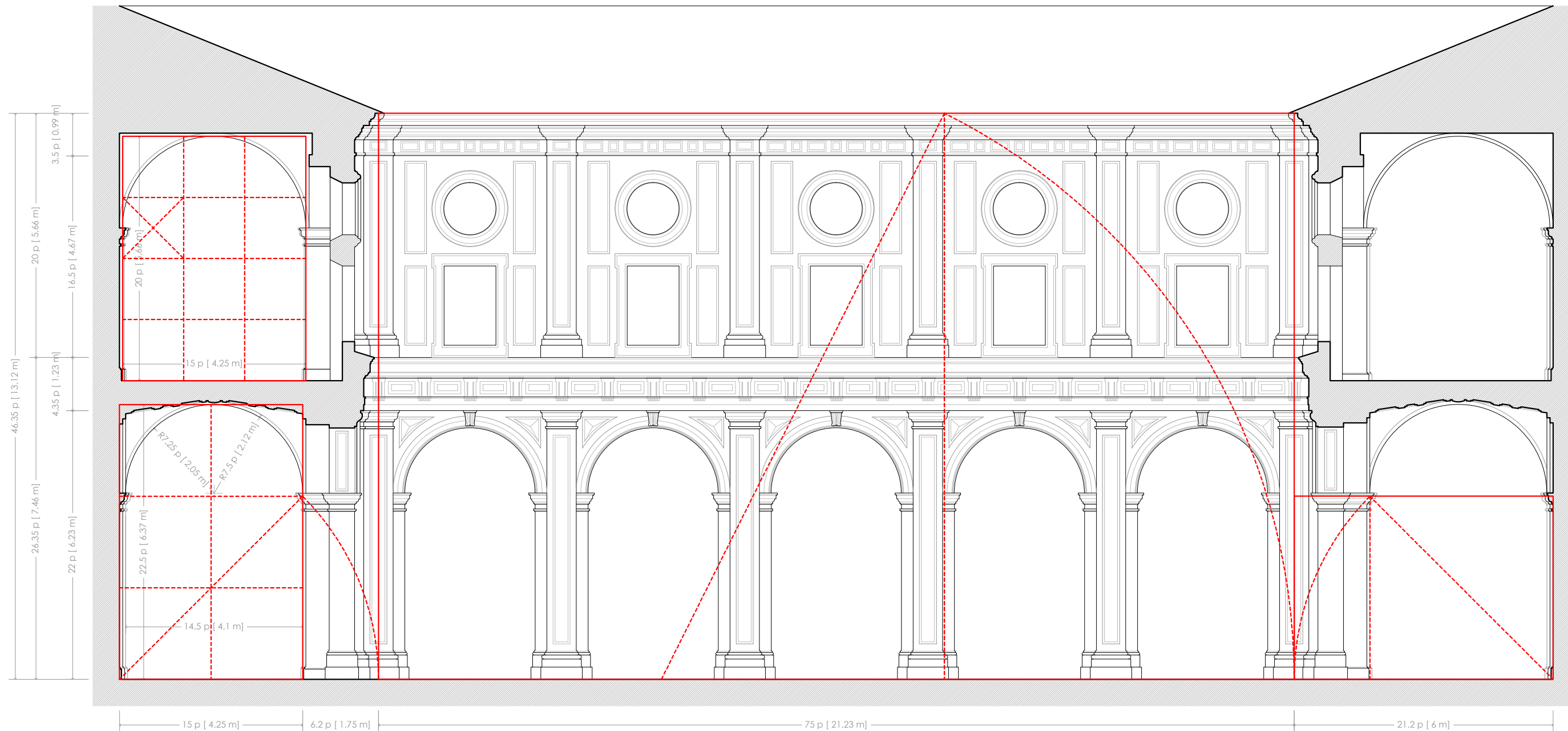

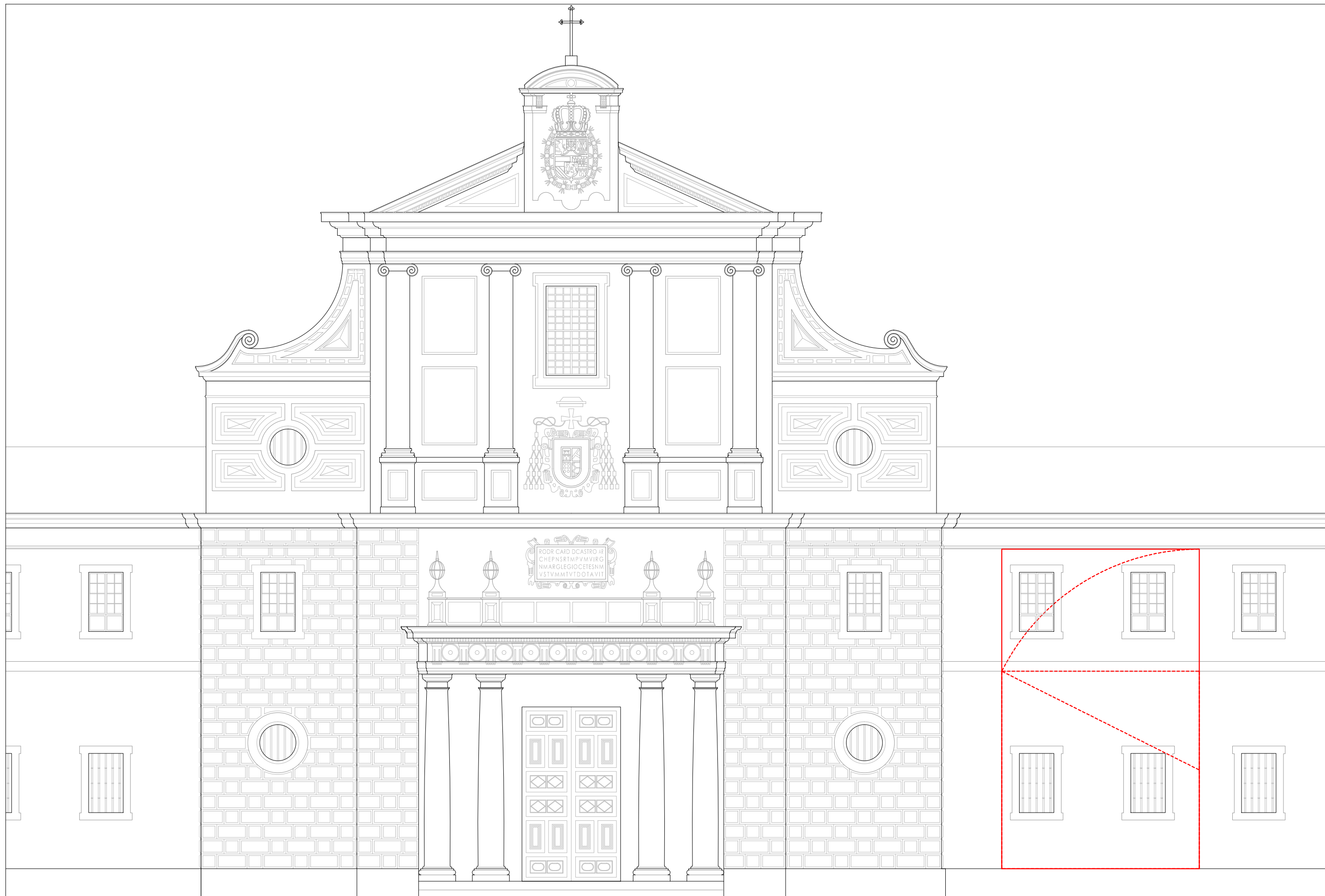

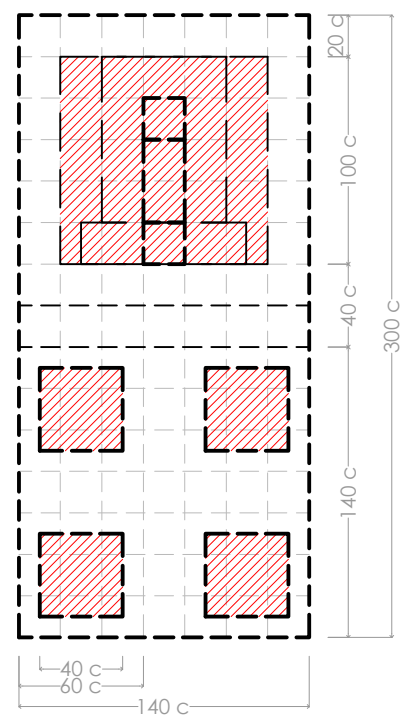

TEMPLO DE SALOMÓN. 140x300 codos

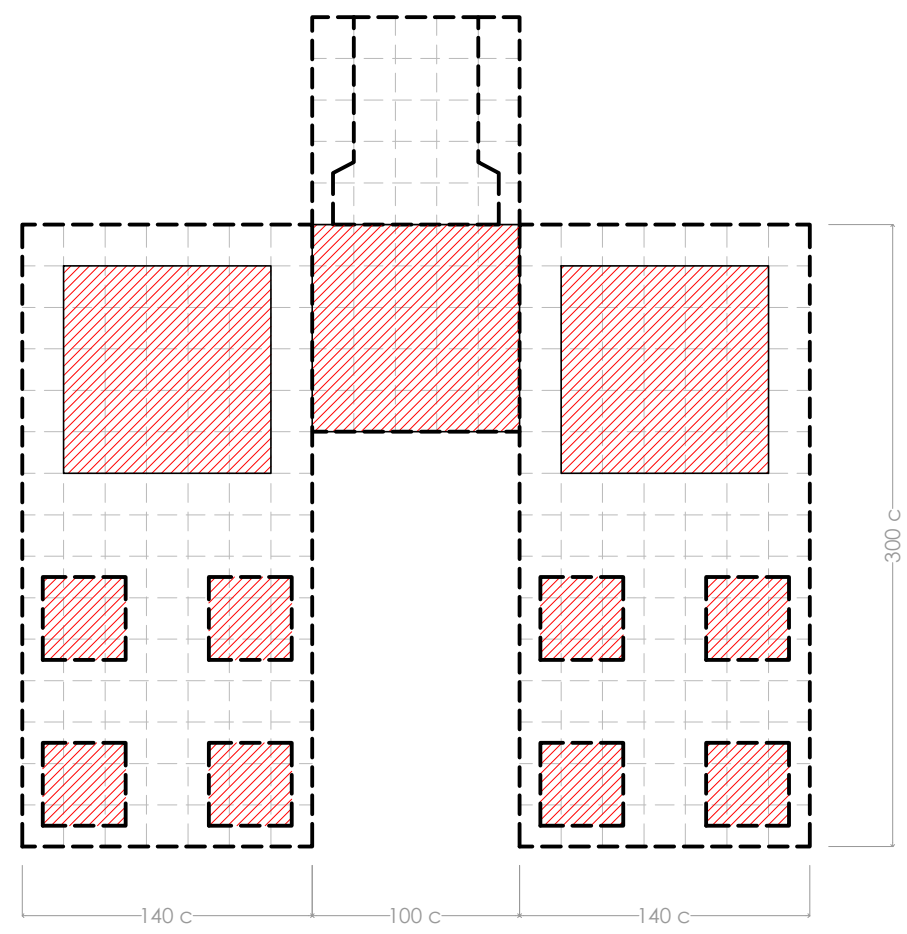
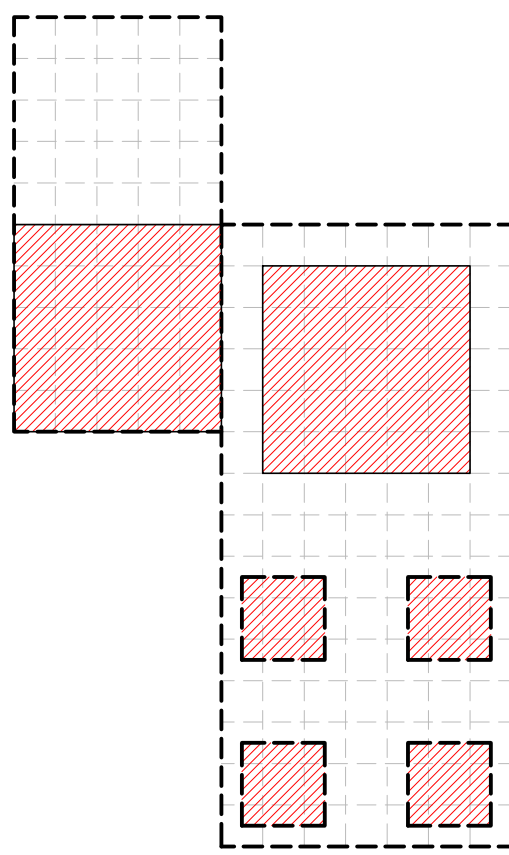

MONASTERIO DEL ESCORIAL. 380x300 codos

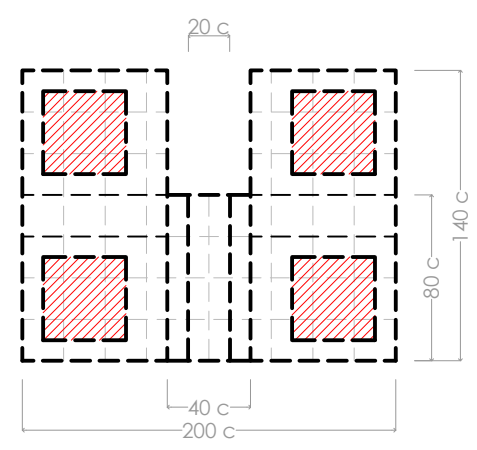
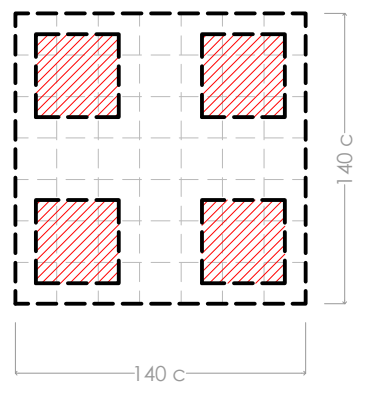
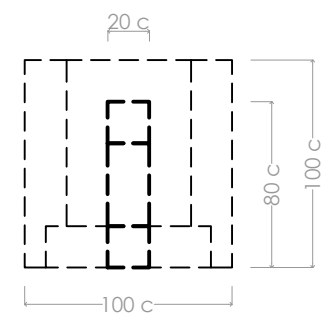

COLEGIO DEL CARDENAL. 140x200 codos