

# Síntese para uma aproximação da arquitetura de Oscar Niemeyer utilizando a geometria fixa e dinâmica moderna.

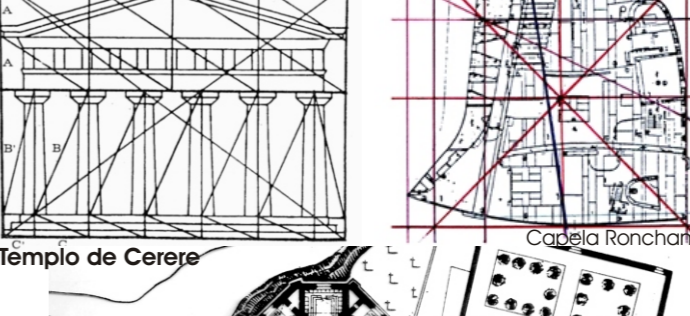
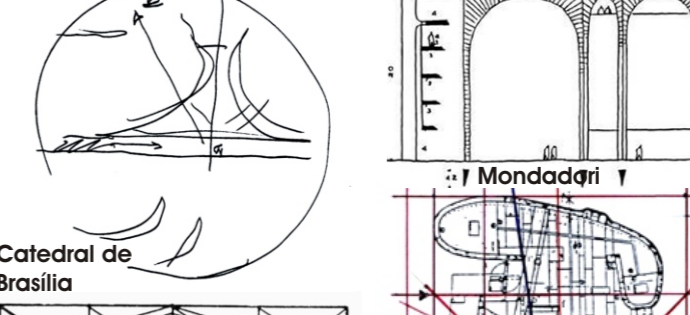
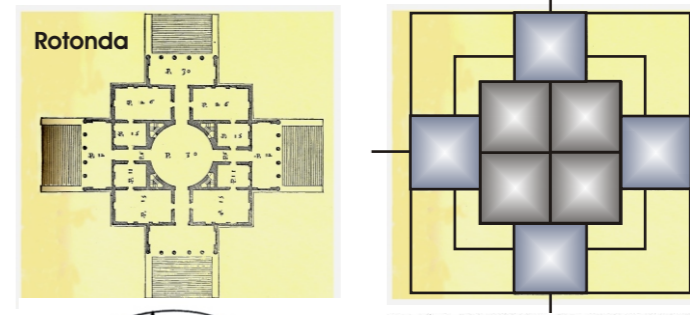
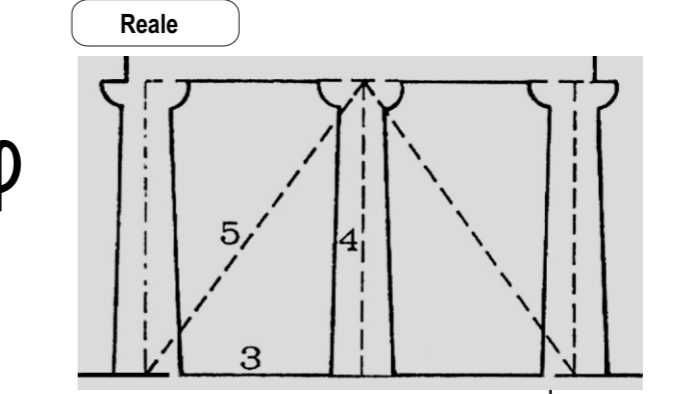
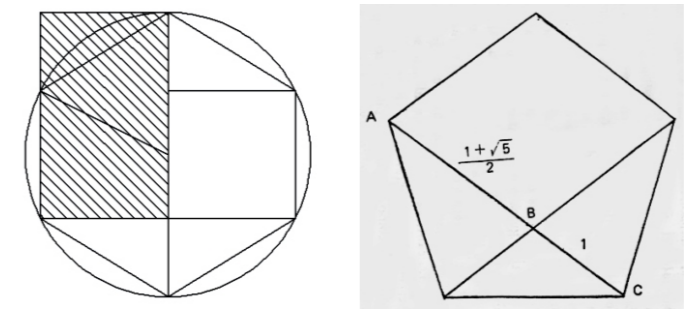
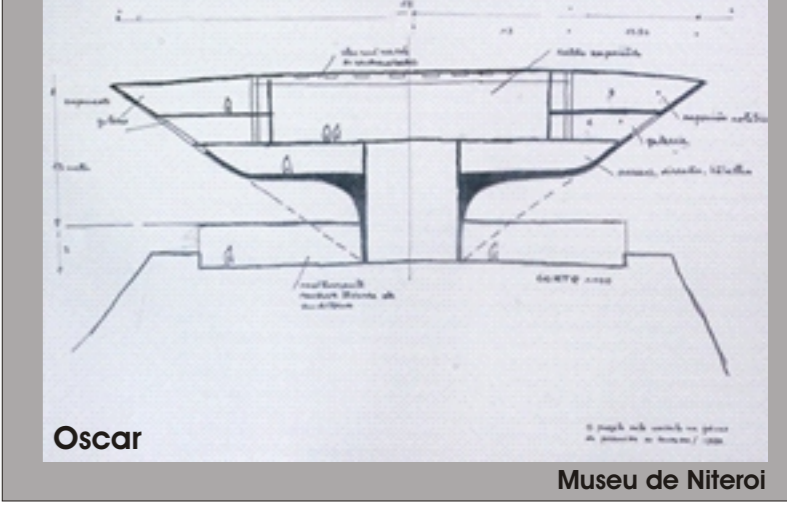
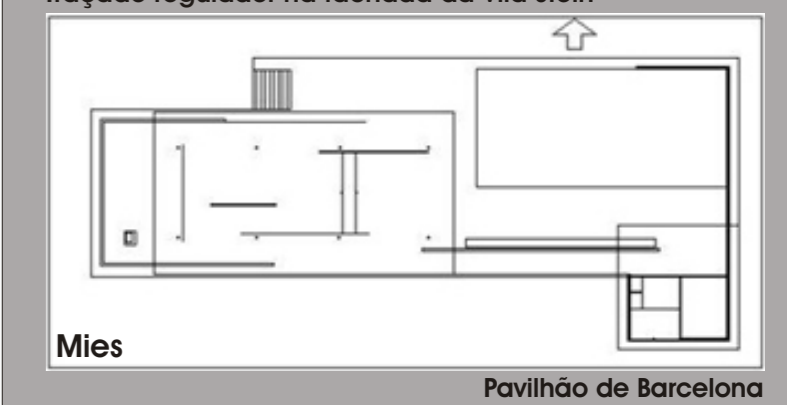
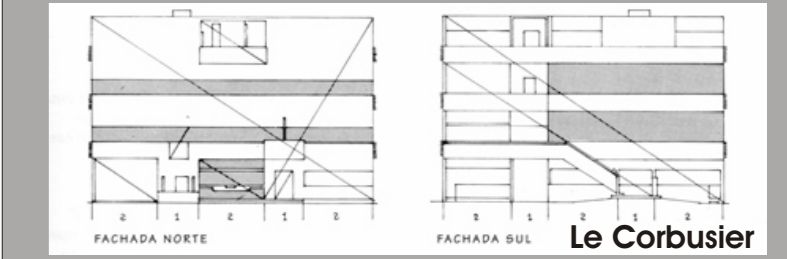
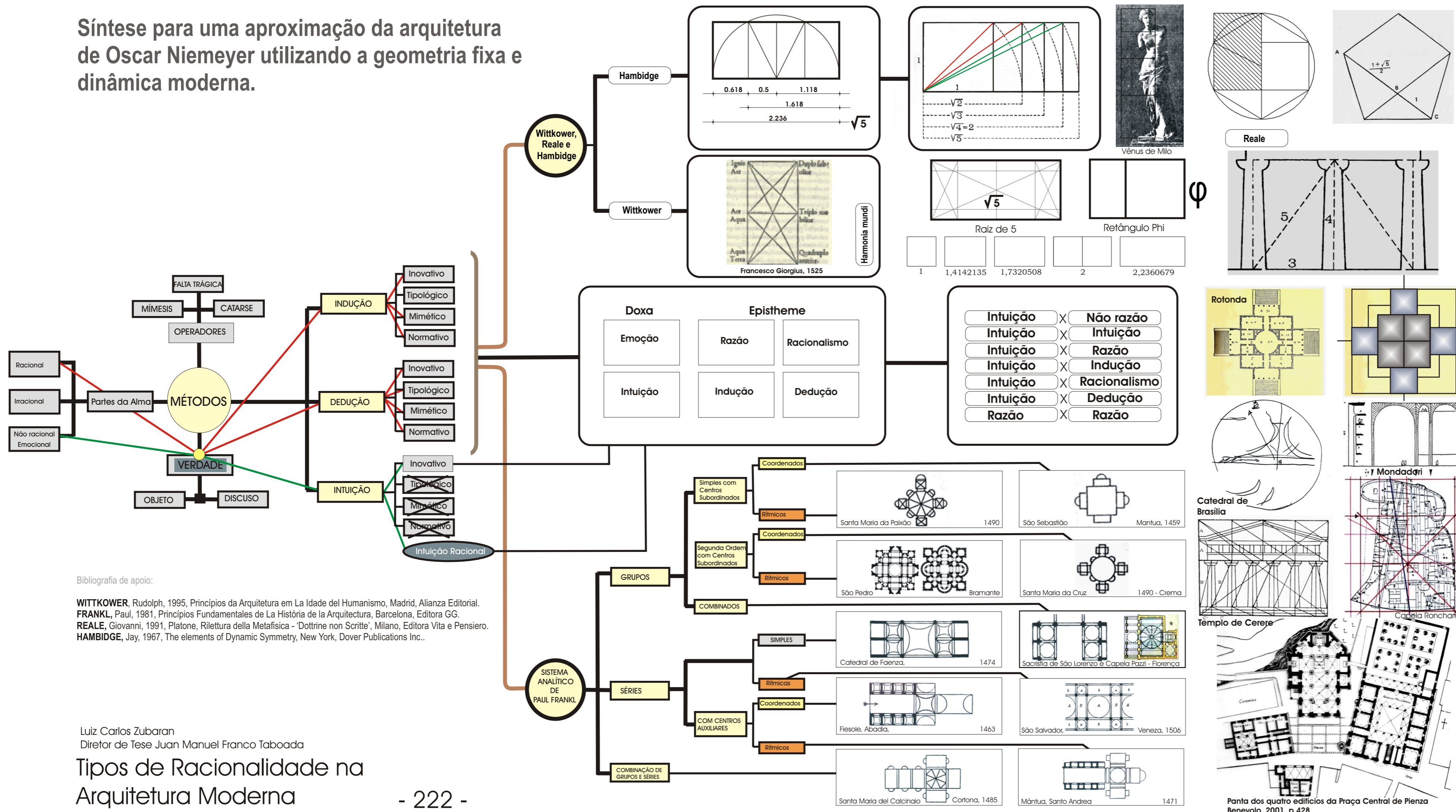

Bibliografia de apoio:  
**WITTKOWER**, Rudolph, 1995, Principios da Arquitetura em La Idade del Humanismo, Madrid, Alianza Editorial.  
**FRANKL**, Paul, 1981, Principios Fundamentales de La História de la Arquitectura, Barcelona, Editora GG.  
**REALE**, Giovanni, 1991, Platone, Rilettura della Metafisica - 'Dottrine non Scritte', Milano, Editora Vita e Pensiero.  
**HAMBIDGE**, Jay, 1967, The elements of Dynamic Symmetry, New York, Dover Publications Inc..

Luiz Carlos Zubaran  
 Diretor de Tese Juan Manuel Franco Taboada  
**Tipos de Racionalidade na  
 Arquitetura Moderna**